

Sistemas de correderas y correderas elevables Sliding and lift-and-slide systems

Los sistemas de correderas elevables de Schüco ofrecen una perfecta estanqueidad y un mayor aislamiento térmico y acústico. Permiten además soluciones antirrobo.

Schüco lift-and-slide systems are absolutely weathertight and offer increased thermal and sound insulation. Burglar-resistant solutions are also possible.



Schüco ASS 50.NI

Sistema de correderas y correderas elevables sin aislamiento térmico para acristalamientos de gran superficie

Non-insulated sliding and lift-and-slide system for large glazed areas

Página 67
Page 67



Schüco ASS 50

Sistema de correderas y correderas elevables con aislamiento térmico y anchos de vista finos

Non-insulated sliding construction with narrow face widths

Página 73
Page 73



Schüco ASS 70.HI

Sistema de correderas elevables con un elevado aislamiento térmico

Highly thermally insulated lift-and-slide system

Página 91
Page 91



Schüco ASS 50.NI

El sistema de correderas y correderas elevables sin aislamiento térmico admite grandes acristalamientos de hasta 150 kg. El cerco y la hoja están ensamblados a inglete en las cuatro esquinas.

The non-insulated sliding and lift-and-slide system can support large glass formats up to 150 kg. Outer and vent frames are mitre cut on all corners.

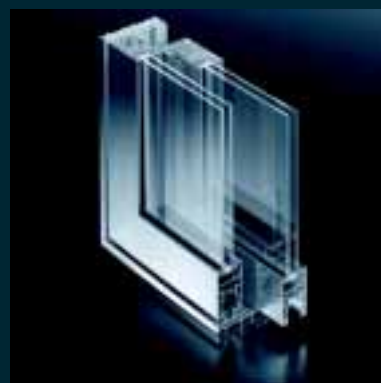

68 Características y ventajas
Features and benefits

70 Posibilidades de aplicación
Possible applications

Schüco ASS 50.NI

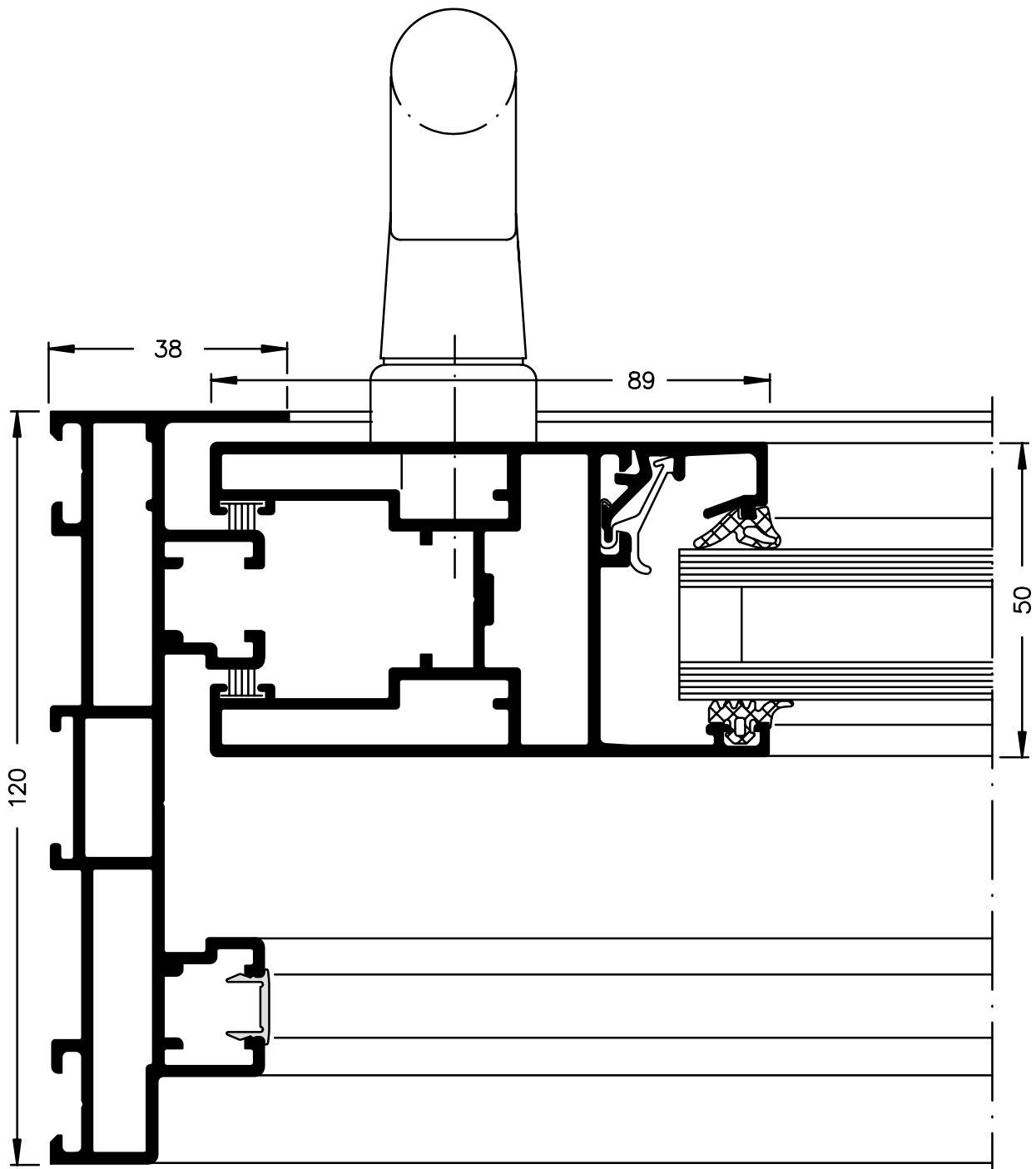

Escala 1:1

Scale 1:1

Características y ventajas

Features and benefits

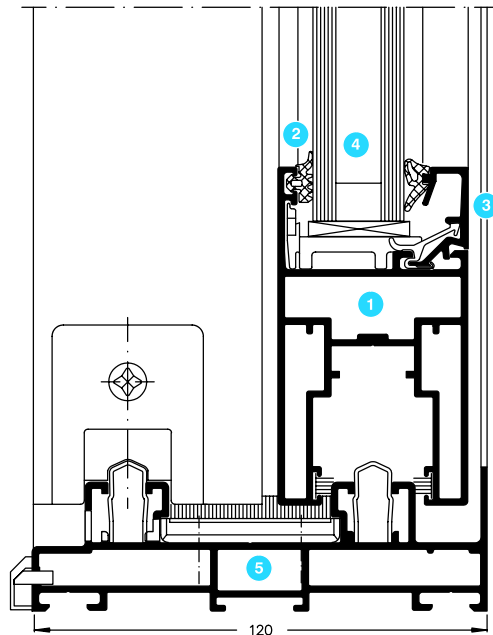

Escala 1:2
Scale 1:2

Estética

- Sistema de correderas y correderas elevables sin aislamiento térmico con ancho de vista fino del marco de hoja desde 89 mm; de marco fino y mayor superficie acristalada
- 1 Profundidad de hoja de 50 mm
Profundidad marco de 120 mm
- 2 Juntas de acristalamiento de EPDM con labios poco visibles para evitar las típicas "rayas negras"
- 3 Junquillos enrasados también disponibles con bordes redondeados
- Cerco plano y perimetral
- Cerco y hoja están ensamblados a inglete en las cuatro esquinas

Funcionalidad

- Un soporte de plástico de sujeción rápida ahorra tiempo y asegura un correcto posicionamiento de los calzos
- Clips de sujeción especiales para los junquillos permiten una colocación sencilla y rápida del cristal, compensando posibles tolerancias de los perfiles y la pintura
- 4 Permite espesores de vidrio de 8 a 32 mm
- Se pueden realizar hojas con un peso de hasta 150 kg, incluso con protección antirrobo hasta EF1/WK2
- 5 Versión con dos carriles
- Deslizamiento suave y silencioso de las hojas

Design

- Non-insulated sliding and lift-and-slide system with narrow face width of vent frames from 89 mm, proportionally narrow frames to large panes
- 1 Basic depth of vent profile 50 mm, basic depth of outer frame profile 120 mm
- 2 EPDM glazing gaskets with discreet gasket lips prevent black borders
- 3 Flush-fitted glazing beads also available in a rounded edge design
- Flat outer frame profile as continuous frame
- Outer and vent frames are mitre cut on all corners

Functions

- Clip-in plastic glazing support saves time and ensures secure positioning of the glazing block points
- Special glazing bead clips allow glazing to be inserted quickly and easily. Takes up tolerances from profiles
- 4 Glazing thicknesses of 8 - 32 mm can be used
- Vent weights up to 150 kg possible, also burglar-resistant to EF1 / WK2
- 5 Double track design
- Units slide smoothly and quietly

Posibilidades de aplicación

Possible applications

Versión con 2 carriles

Peso máximo de la hoja: 150 kg

Double track design

Max. vent weight: 150 kg

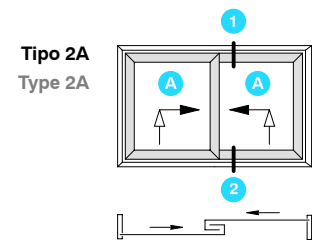

A Hoja corredera/
corredera elevable
S / LS vent

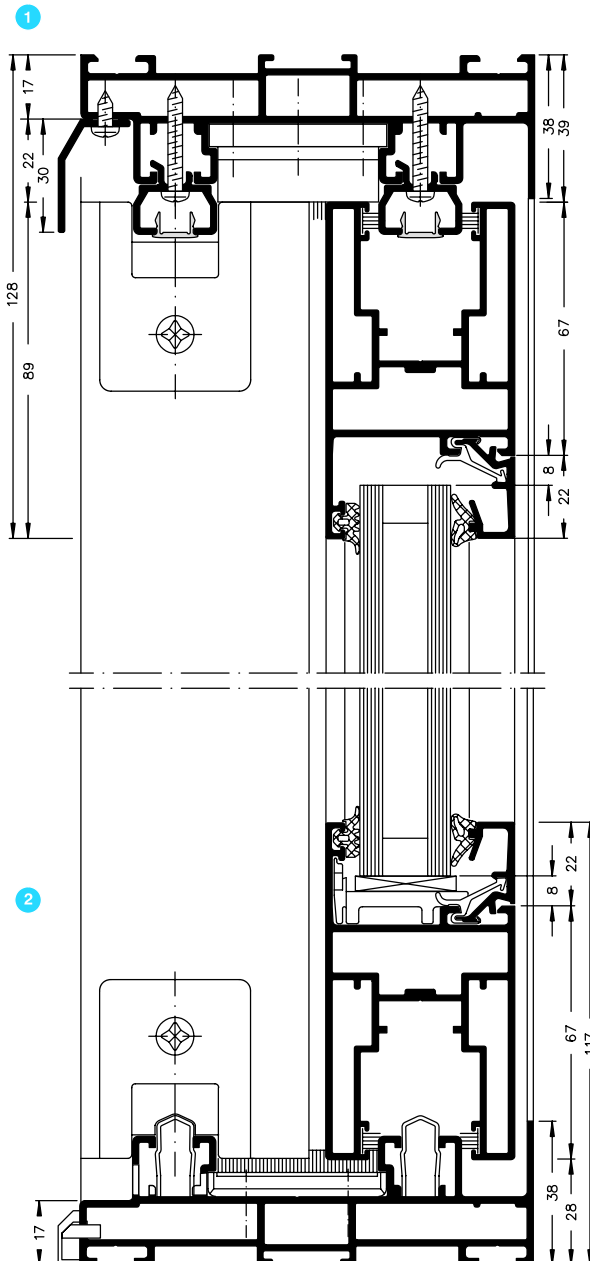

Escala 1:2

Scale 1:2

Encuentro central
Interlock stile; meeting stile

Tipo 2A
Type 2A

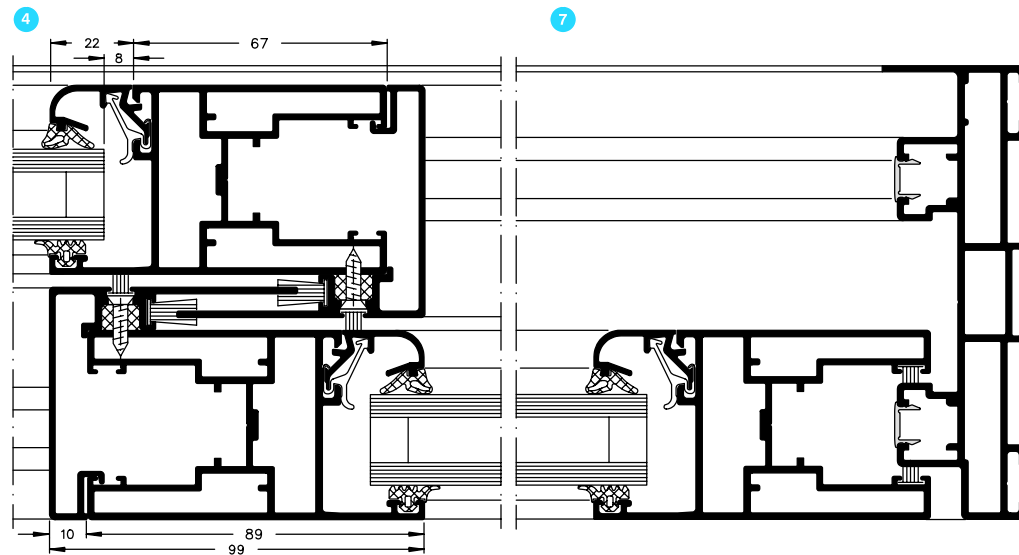
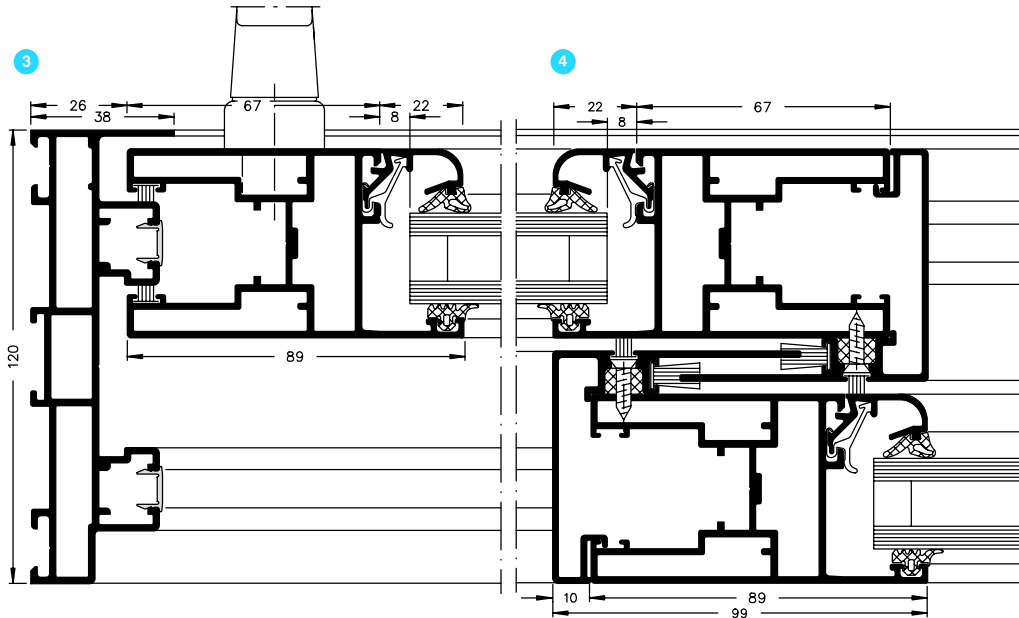
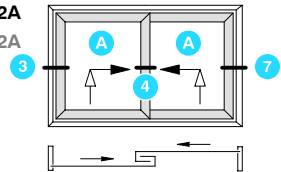

Tipo 2D
Type 2D

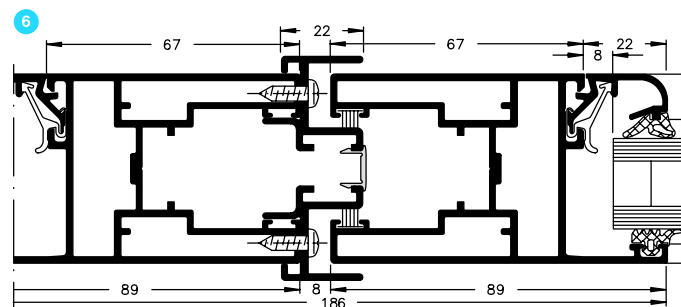
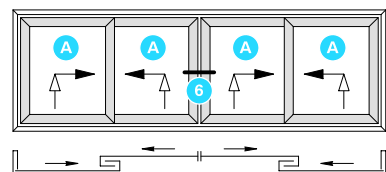

Escala 1:2
Scale 1:2

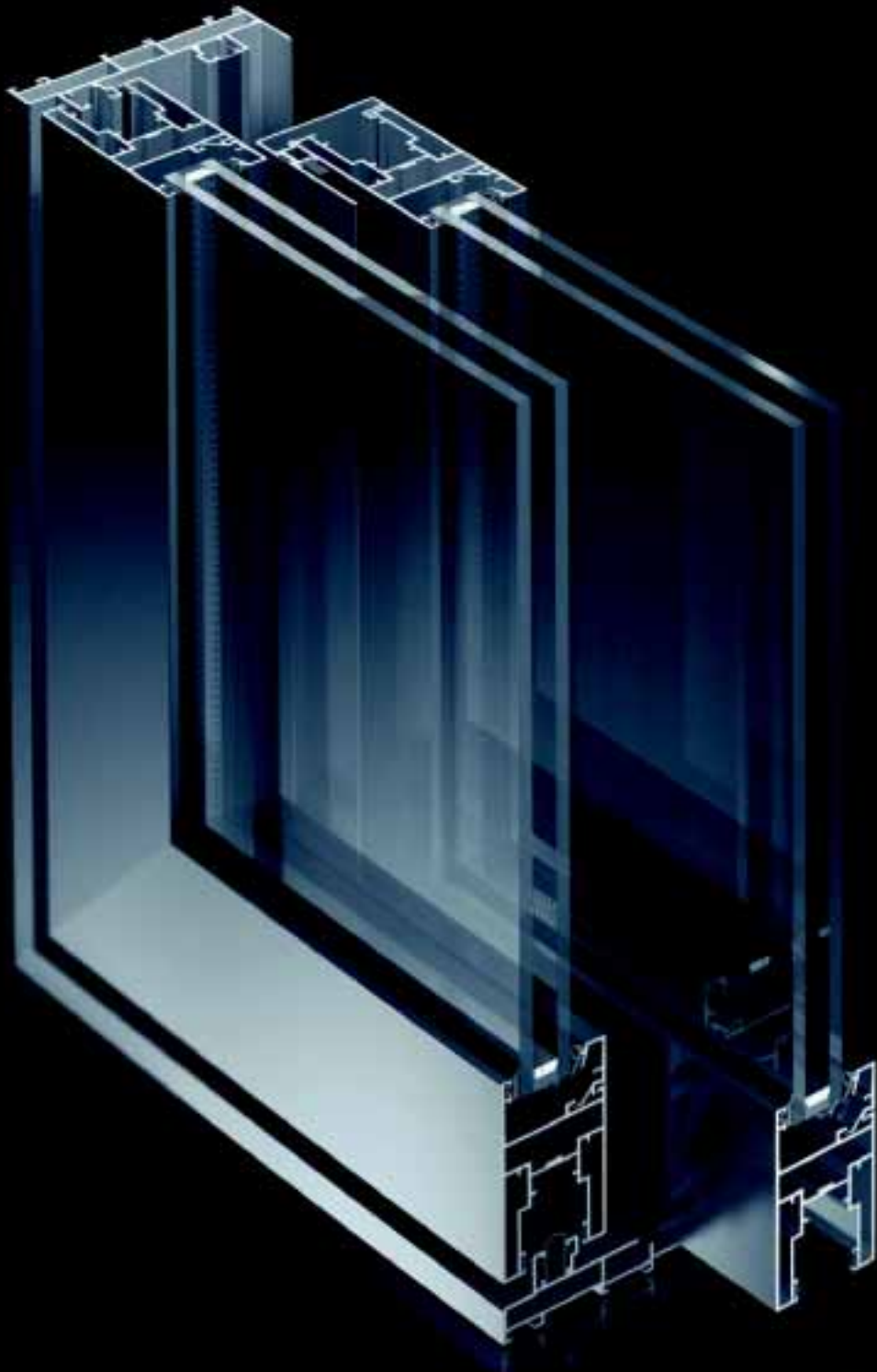

Schüco ASS 50

El sistema de correderas y correderas elevables con aislamiento térmico ofrece marcos de hoja sólidos con anchos de vista finos y una gran variedad de modelos.

The insulated sliding and lift-and-slide system offers impressive solid vent frames with a minimum face width and a wide range of designs.



74 **Características y ventajas**
Features and benefits

76 **Posibilidades de aplicación**
Possible applications

Schüco ASS 50

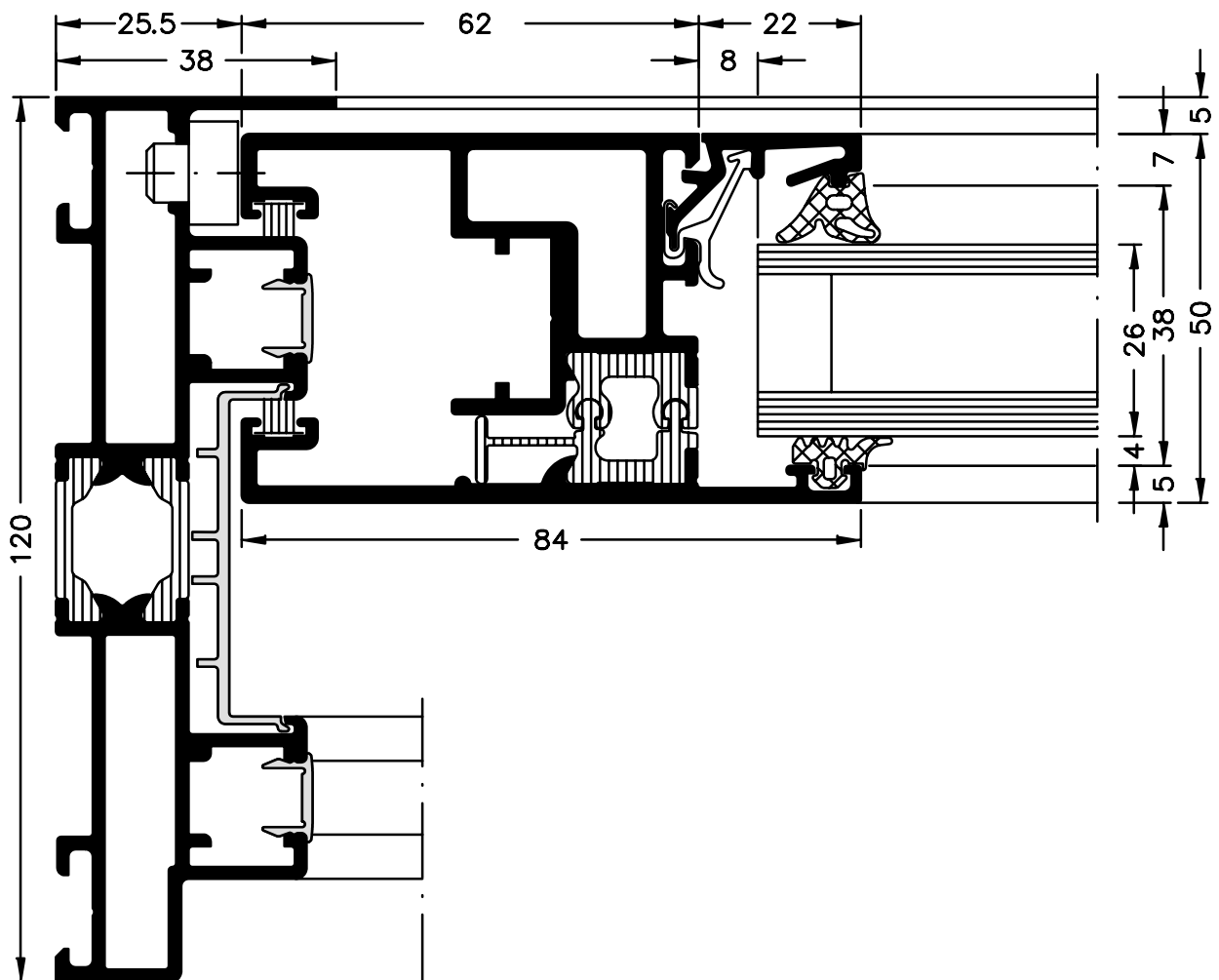

Escala 1:1
Scale 1:1

Características y ventajas

Features and benefits

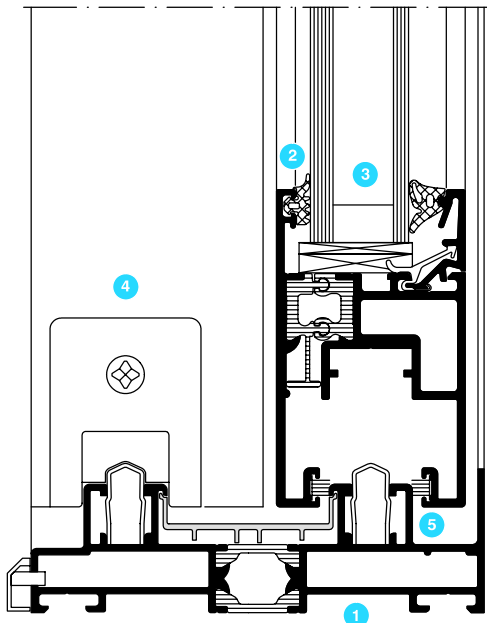

Escala 1:2
Scale 1:2

Estética

- Serie corredera y corredera elevable
- 1 Profundidad de hoja de 50 mm
Profundidad de marco desde 120 mm
- 2 Juntas de acristalamiento de EPDM con labios poco visibles para evitar las típicas "rayas negras"
- Junquillos enrasados también disponibles con bordes redondeados
- Cerco plano y perimetral; umbral plano para una mejor accesibilidad
- Cerco y hoja están ensamblados a inglete en las cuatro esquinas para ofrecer una apariencia elegante

Funcionalidad

- Gran variedad de colores con posibilidad de elegir diferentes tonos para el interior y exterior
- Alto grado de flexibilidad para proyectos comerciales mediante ensamblaje de los perfiles
- 3 Permite espesores de vidrio de 8 a 32 mm
- Estanqueidad al agua de hasta clase 9a según DIN EN 12208, en función de la versión
- Se pueden realizar hojas con un peso de hasta 300 kg
- Gran variedad de modelos, opcionalmente con uno, dos o tres carriles de acero inoxidable
- 4 La construcción puede combinarse con montantes, hojas laterales fijas o las series Schüco AWS 50 o Schüco AWS 65
- Protección antirrobo WK2 según DIN EN V 1627 en función de la versión
- Aislamiento térmico según DIN EN ISO 10077, parte 1, $U_D < 2,0$ (W/m²K)

Design

- Slide and Lift-and-slide series
- 1 Basic depth of vent profile 50 mm, basic depth of outer frame profile 120 mm
- 2 EPDM glazing gaskets with discreet gasket lips prevent black borders
- Flush-fitted glazing beads also available in a rounded edge design
- Flat outer frame profile as continuous frame, low threshold for easy access
- Outer and vent frames are mitred all round, to give an elegant appearance

Functions

- Wide choice of colours, different colours inside and outside
- High degree of flexibility with large-scale projects for customers to roll own profiles together
- 3 Glazing thicknesses of 8 – 32 mm can be used
- Weathertightness up to class 9A in accordance with DIN EN 12208, dependent on design
- Vent weights up to 300 kg
- Wide variety, with one, two or three stainless steel tracks
- 4 The construction can be combined with Schüco AWS 50 or Schüco AWS 65 toplights, side lights or infill panels.
- Burglar resistance class WK 2 in accordance with DIN EN V 1627, dependent on design
- Thermal insulation in accordance with DIN EN ISO 10077, Part 1 $U_D < 2.0$ (W/m²K)

Posibilidades de aplicación

Possible applications

Versión con 1 carril

Peso máximo de la hoja: 150 kg

Single track design

Max. vent weight: 150 kg

Tipo 1A
Type 1A

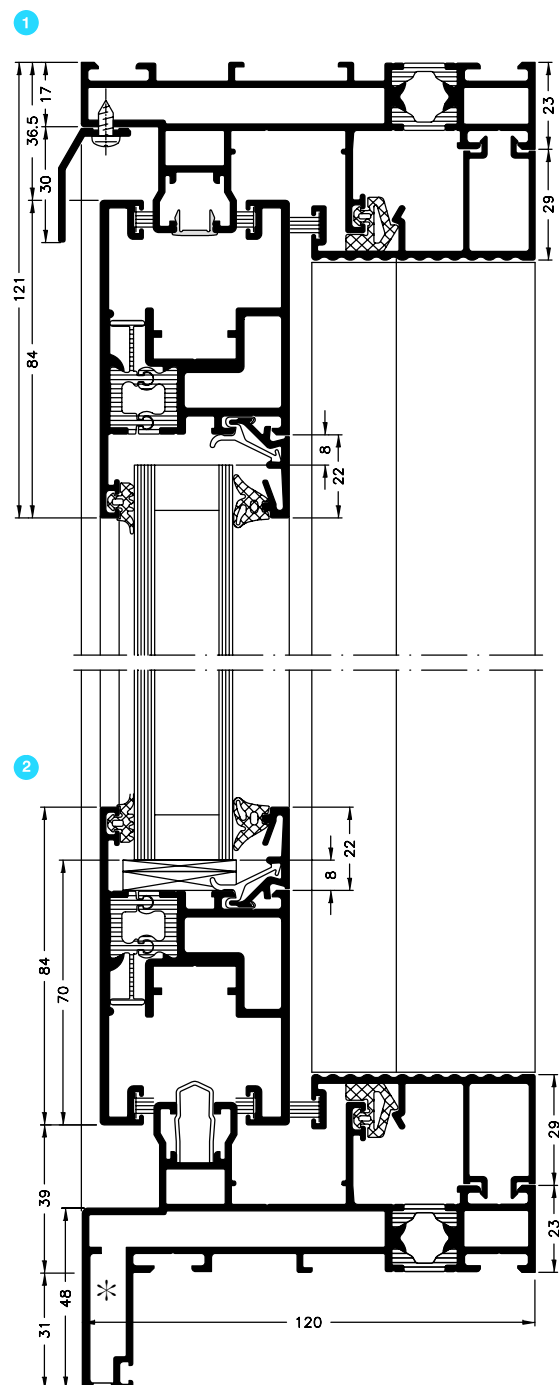
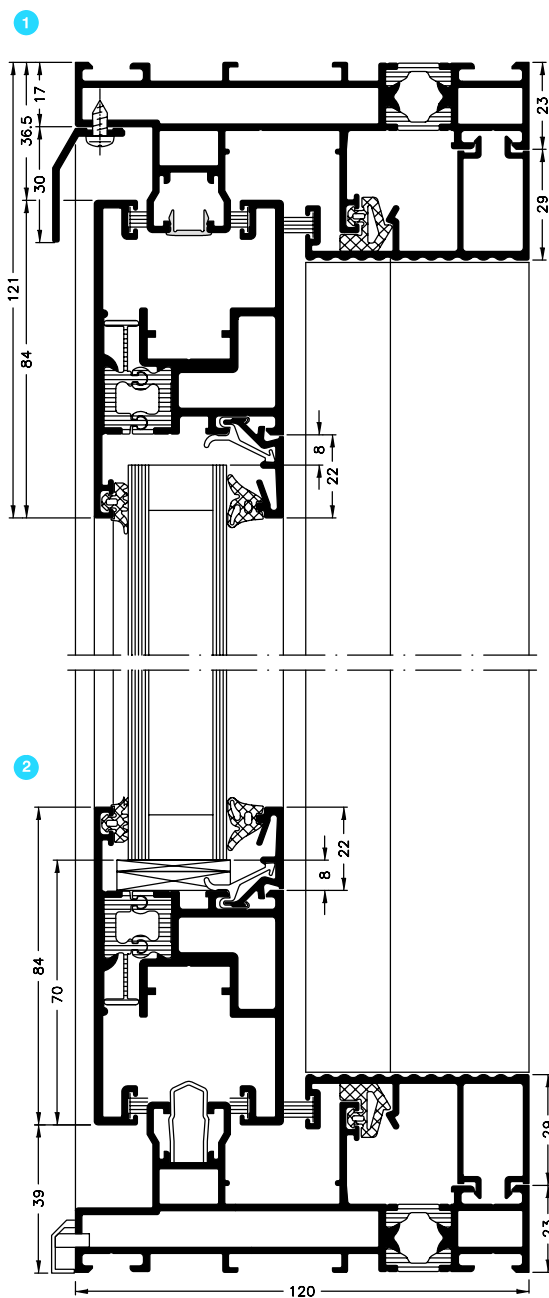
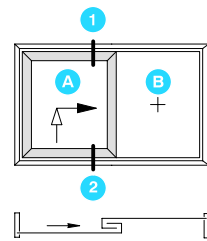

Escala 1:2
Scale 1:2

* Cerco para una mayor estanqueidad al agua
Outer frame for increased weathertightness

A Hoja corredera / corredera elevable
S / LS vent

B Acristalamiento en cerco
Glazing in outer frame

Tipo 1A
Type 1A

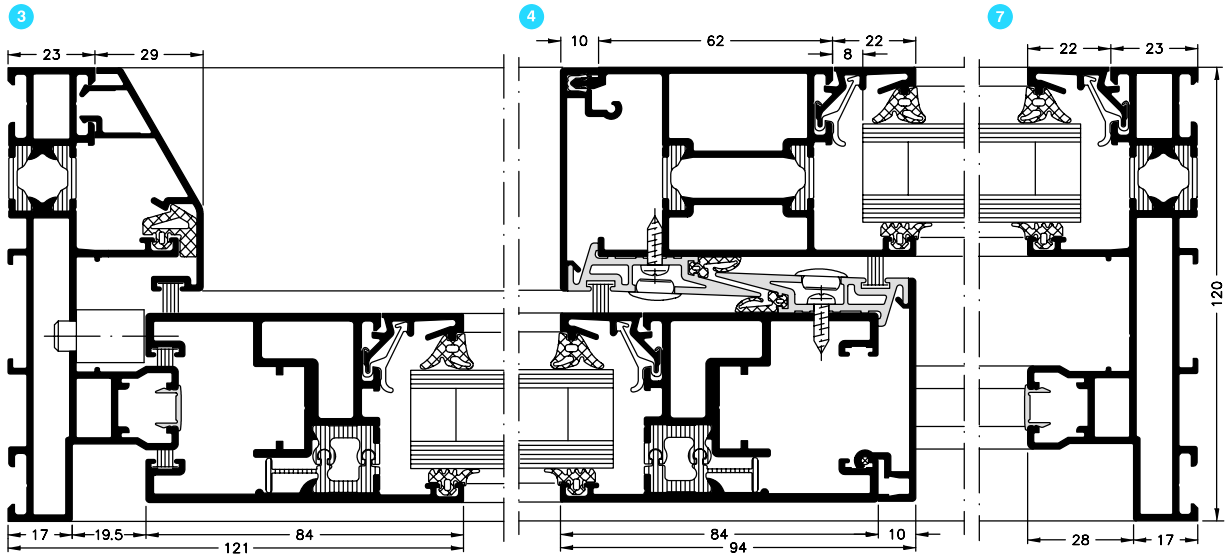
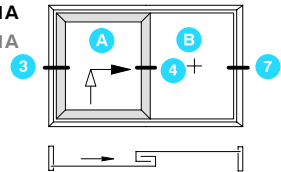

Tipo 1D
Type 1D

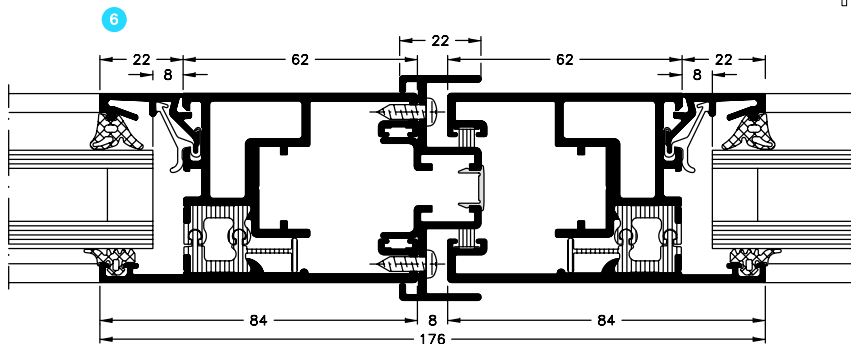
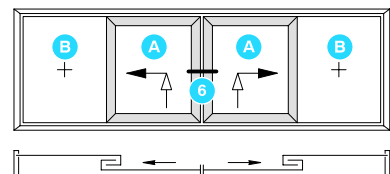

Escala 1:2
Scale 1:2

Versión con 1 carril
 Peso máximo de la hoja: 300 kg
 Single track design
 Max. vent weight: 300 kg

Tipo 1A
Type 1A

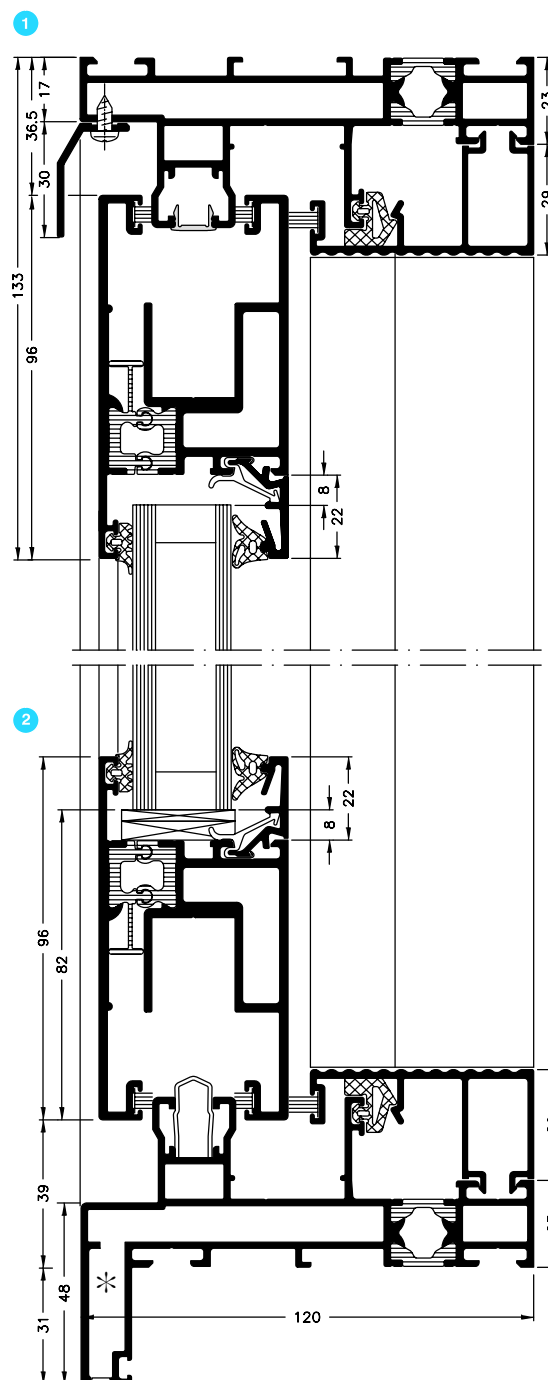
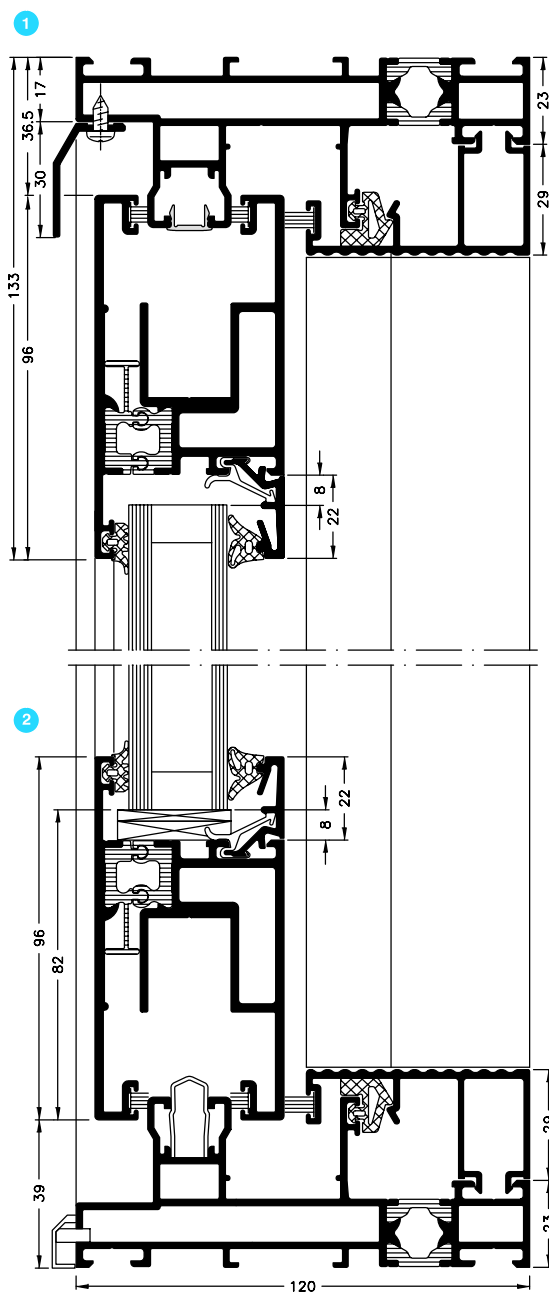
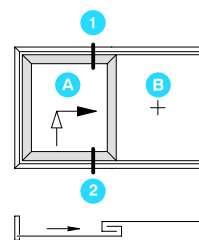

Escala 1:2
 Scale 1:2

* Cerco para una mayor estanqueidad al agua
 Outer frame for increased weathertightness

A Hoja corredera / corredera elevable
S / LS vent

B Acristalamiento en el cerco
Glazing in outer frame

Tipo 1A
Type 1A

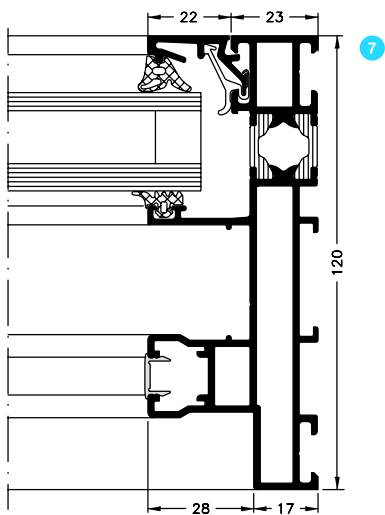
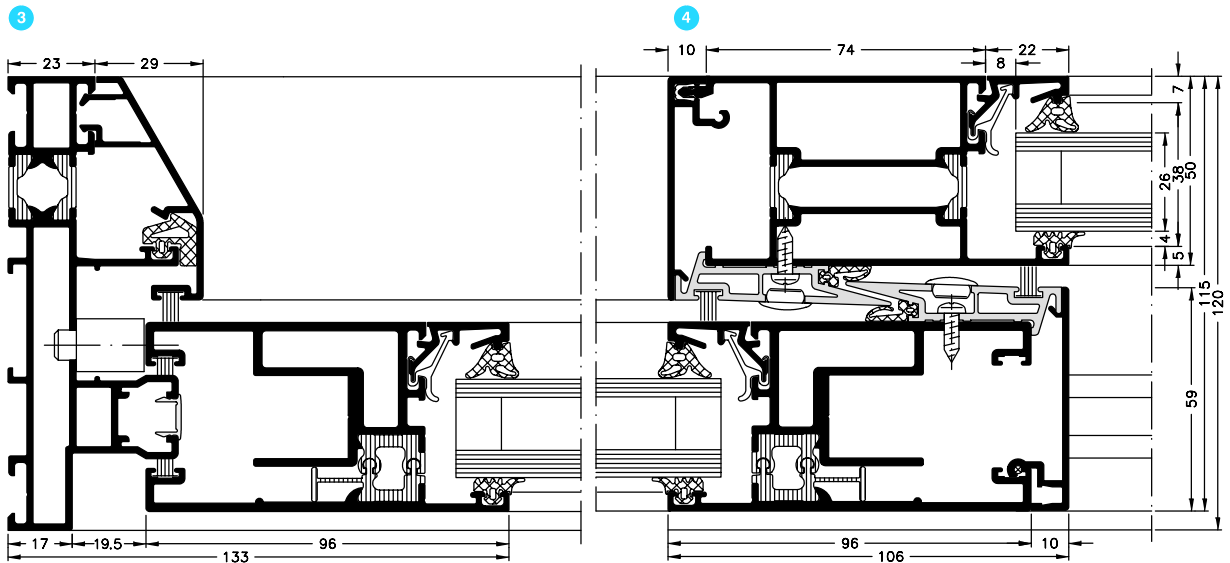
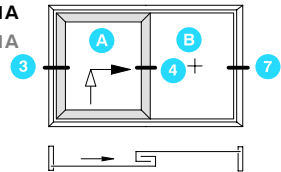

Tipo 1D
Type 1D

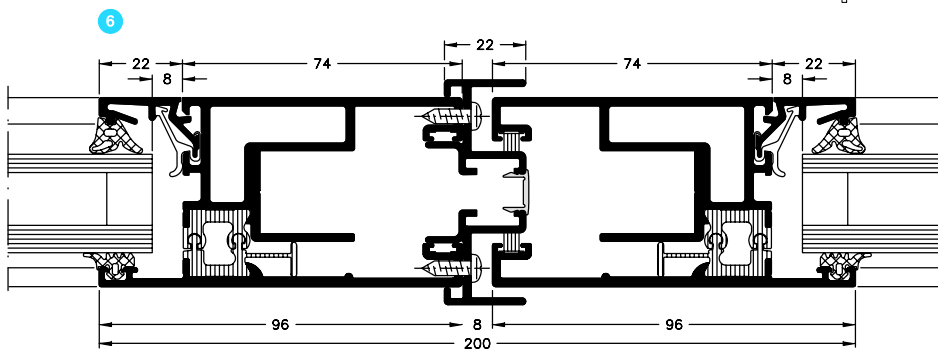
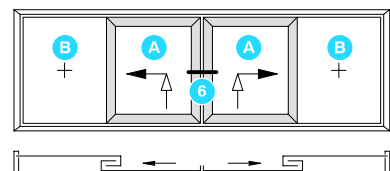

Escala 1:2
Scale 1:2

Versión con 2 carriles
 Peso máximo de la hoja: 150 kg
 Double track design
 Max. vent weight: 150 kg

Tipo 2A/1
Type 2A/1

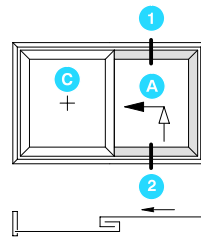

Tipo 2A
Type 2A

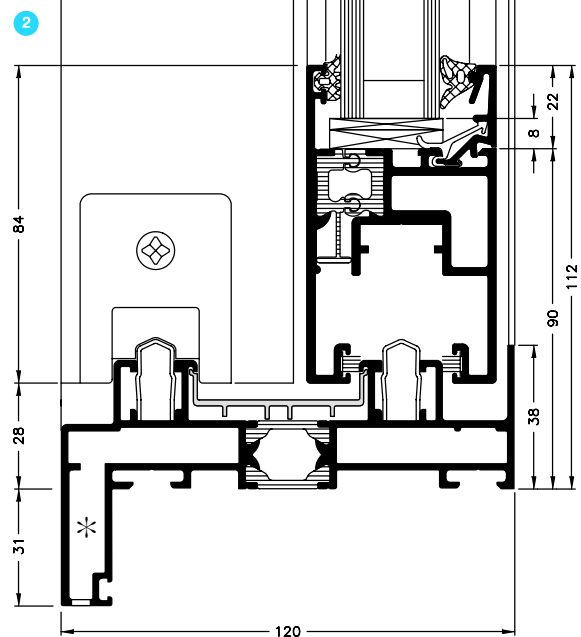
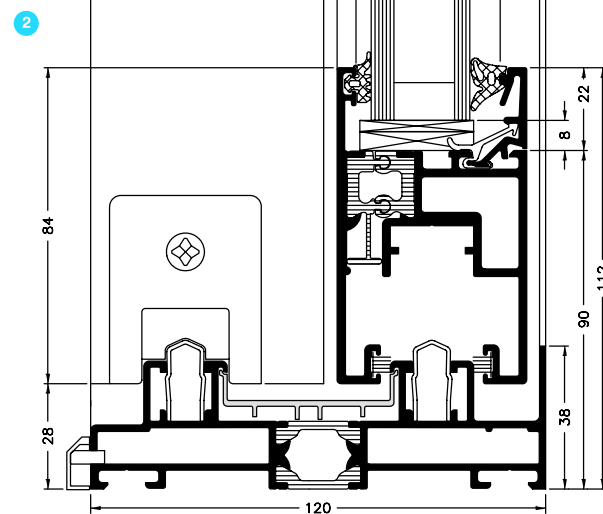
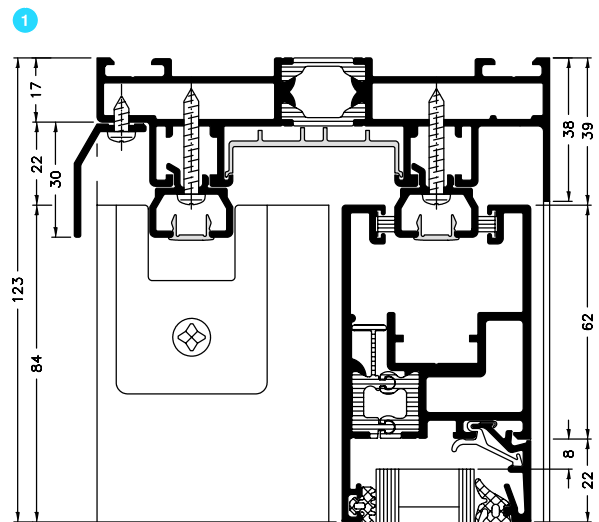
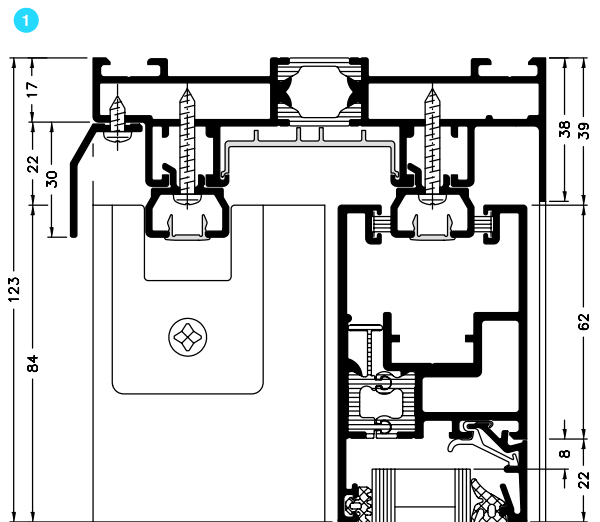
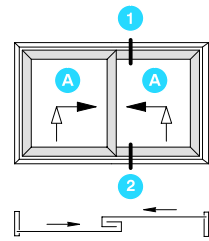

Escala 1:2
 Scale 1:2

* Cerco para una mayor estanqueidad al agua
 Outer frame for increased weathertightness

- A** Hoja corredera / corredera elevable
S / LS vent
- C** Hoja fija
Fixed vent

Tipo 2A/1
Type 2A/1

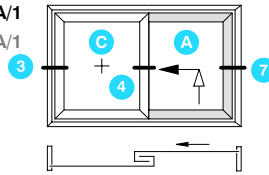

Tipo 2A
Type 2A

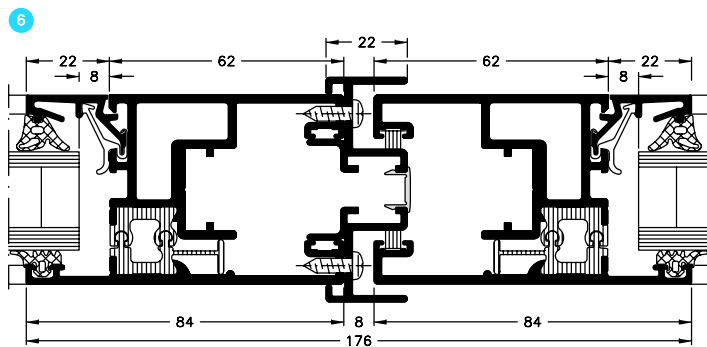
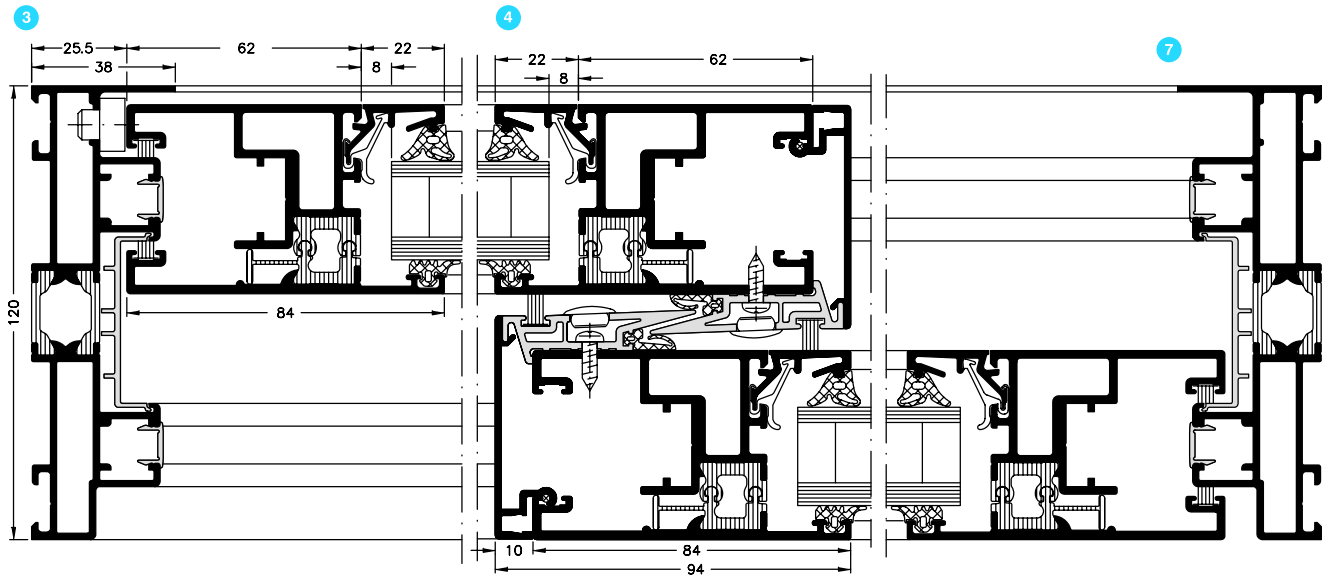
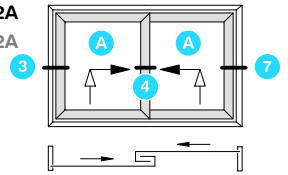

Tipo 2D
Type 2D

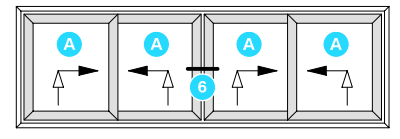

Tipo 2D/1
Type 2D/1

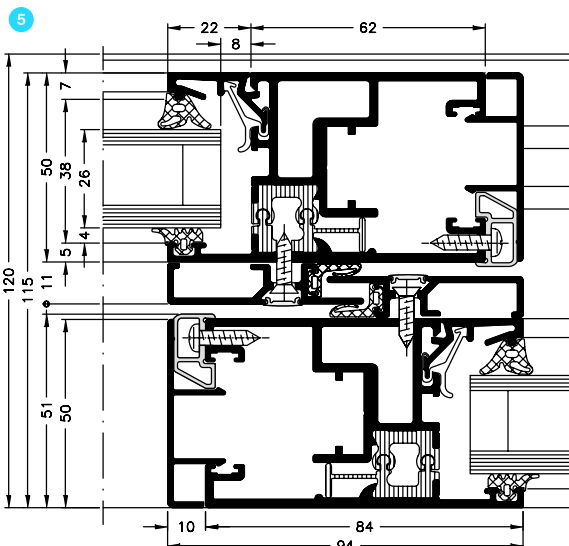
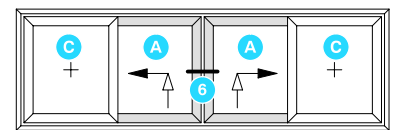

Tipo 2C
Type 2C

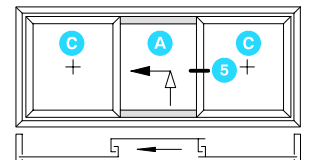

Ejecución con 2 carriles
 Peso máximo de la hoja: 300 kg
 Double track design
 Max. vent weight: 300 kg

Tipo 2A/1
 Type 2A/1

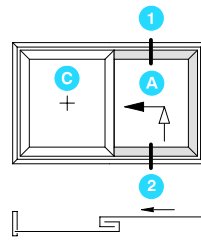

Tipo 2A
 Type 2A

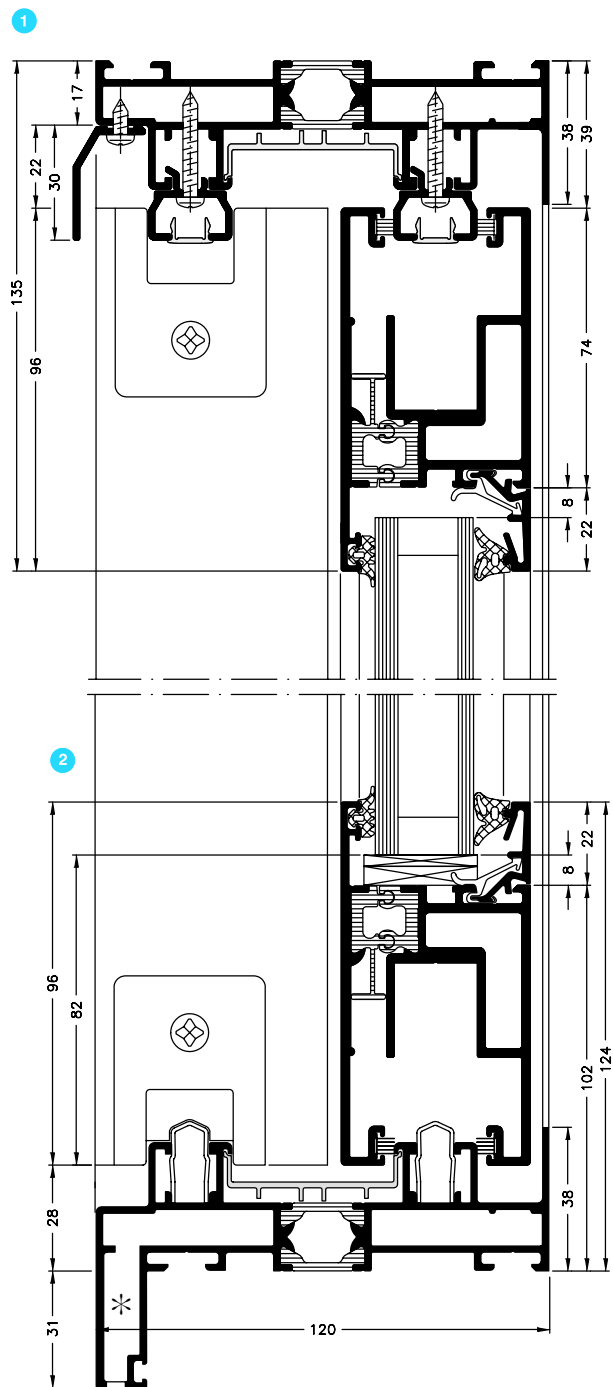
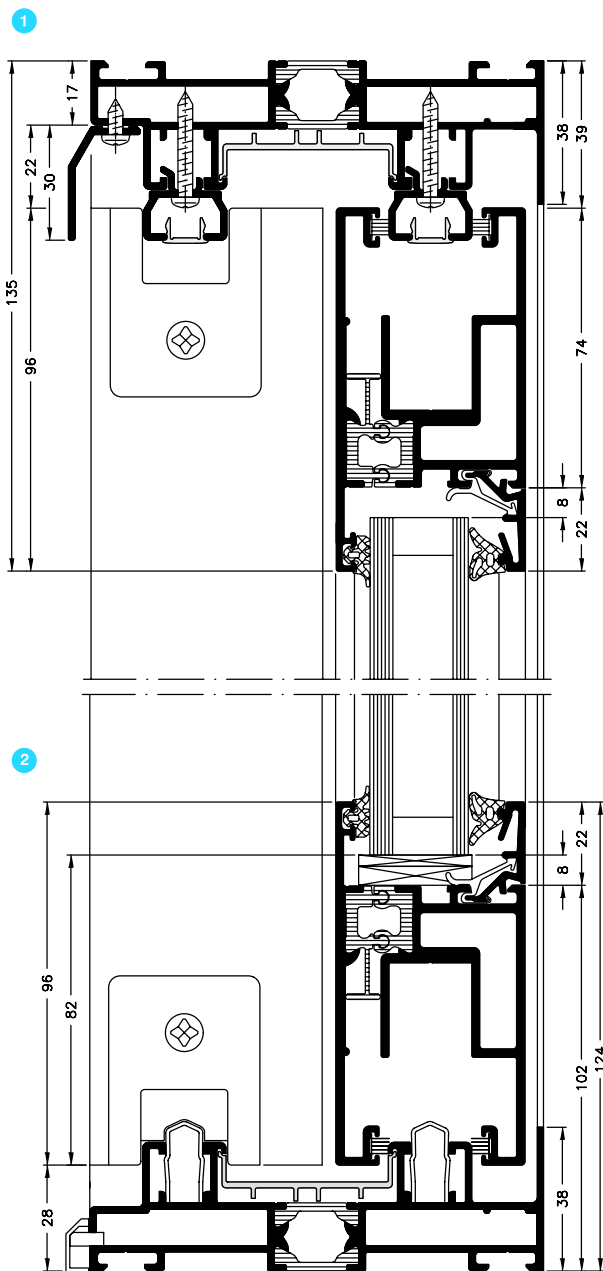
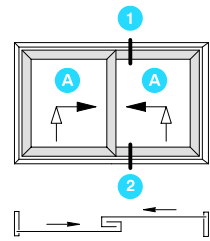

Escala 1:2
 Scale 1:2

* Cerco para una mayor estanqueidad al agua
 Outer frame for increased weathertightness

- A** Hoja corredera / corredera elevable
S / LS vent
- C** Hoja fija
Fixed vent

Tipo 2A/1
Type 2A/1

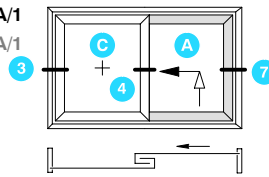

Tipo 2A
Type 2A

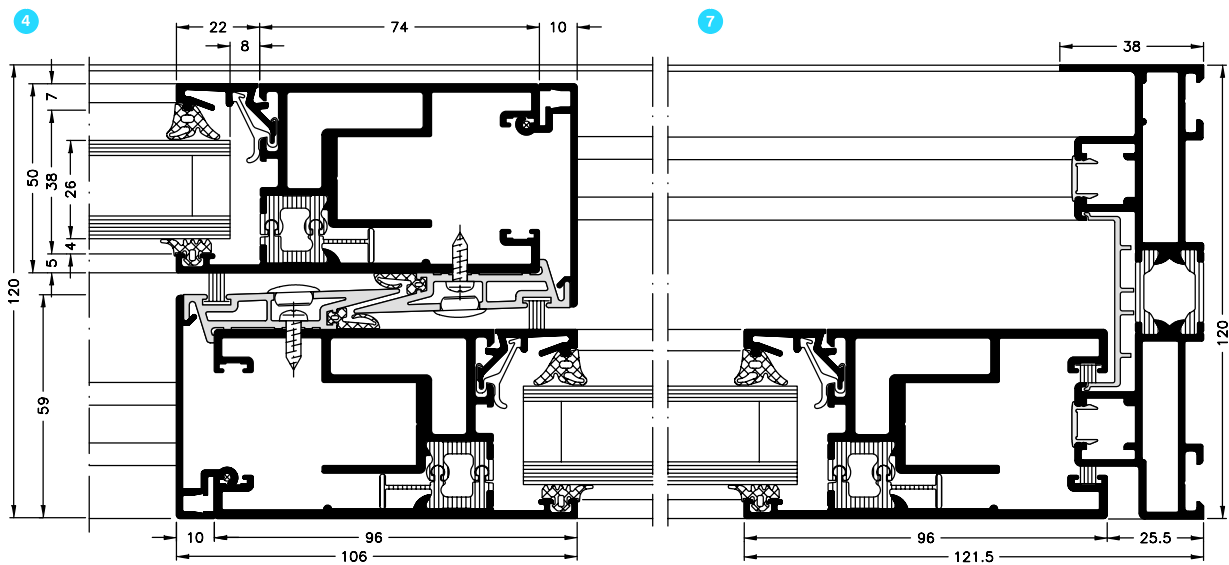
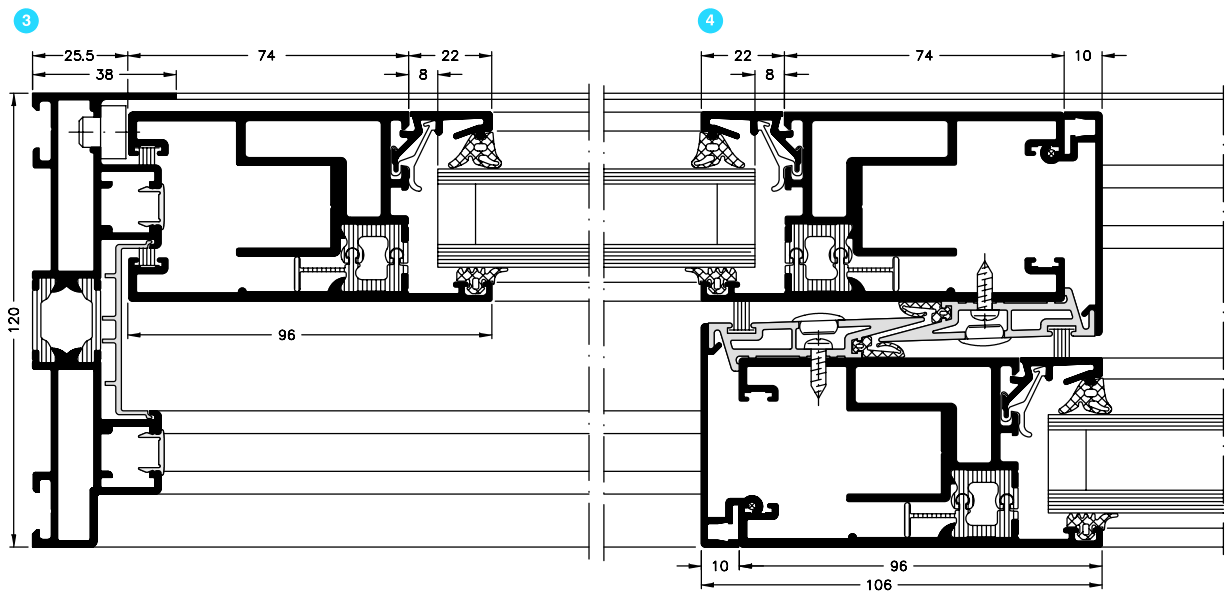
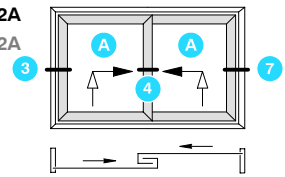

Escala 1:2
Scale 1:2

Versión con 2 carriles
 Peso máximo de la hoja: 300 kg
 Double track design
 Max. vent weight: 300 kg

Tipo 2C
 Type 2C

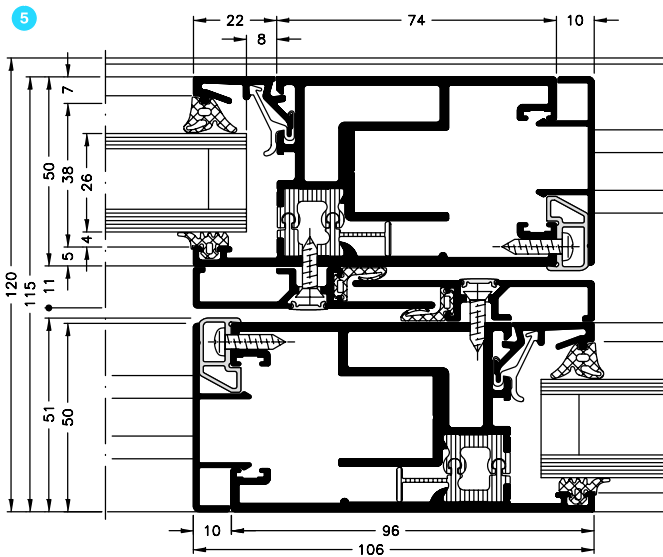
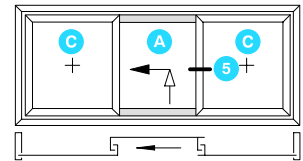

- A** Hoja corredera / corredera elevable
S / LS vent
- C** Hoja fija
Fixed vent

Tipo 2D
 Type 2D

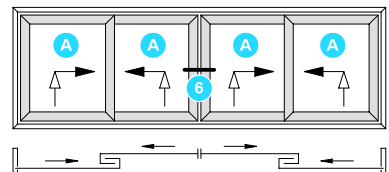

Tipo 2D/1
 Type 2D/1

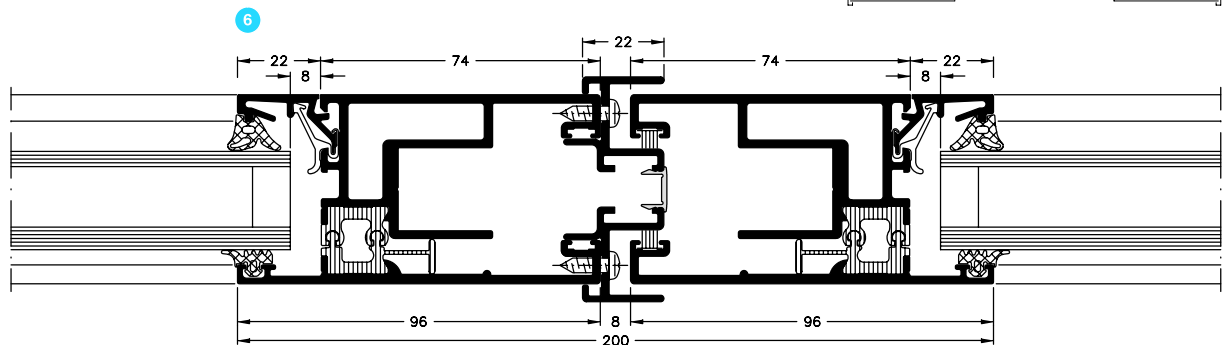
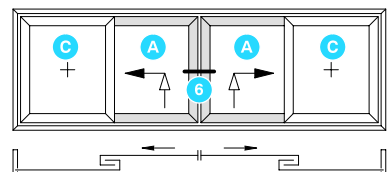

Escala 1:2
 Scale 1:2

Ejecución con 3 carriles
 Peso máximo de la hoja: 150 kg
 Triple track design
 Max. vent weight: 150 kg

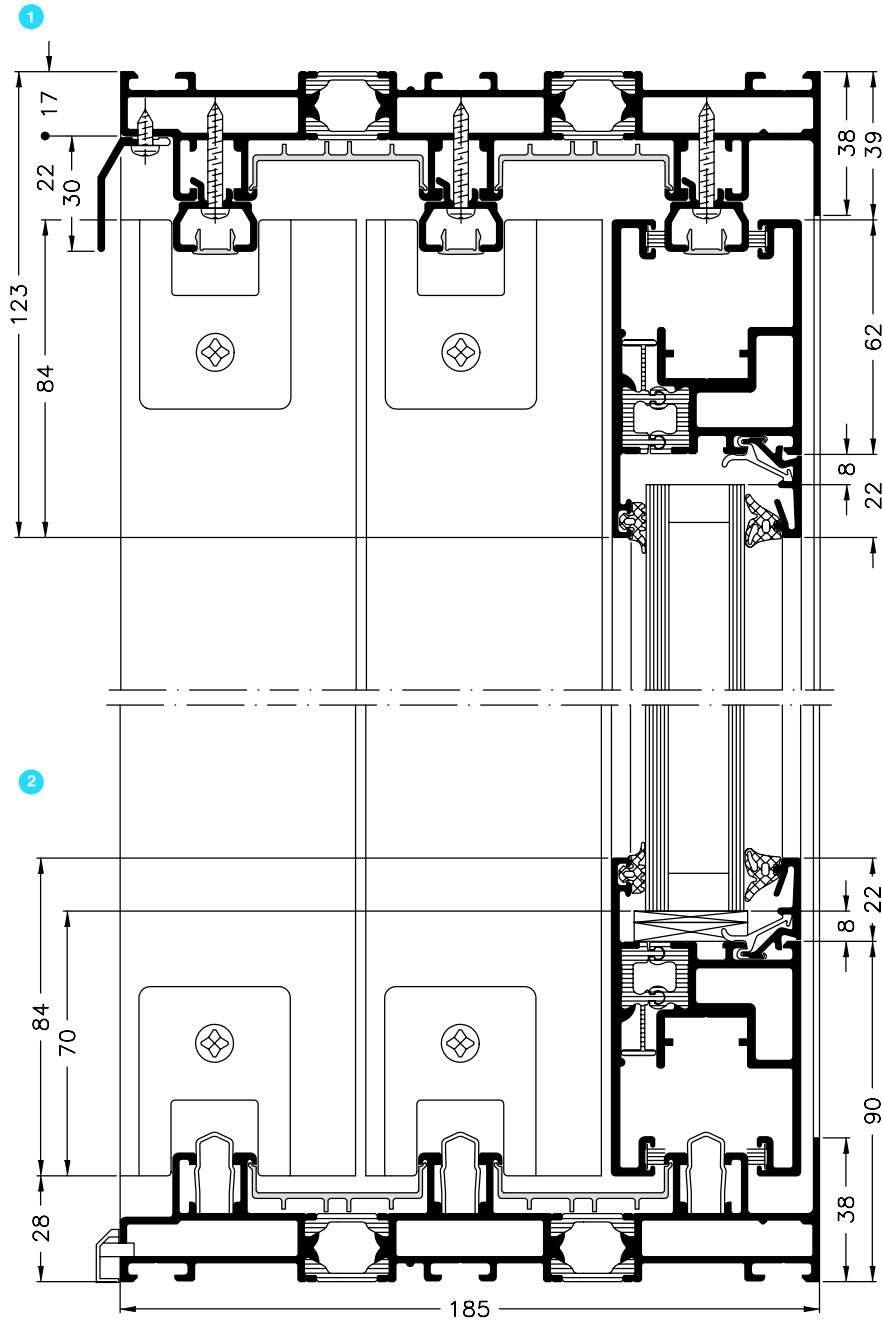
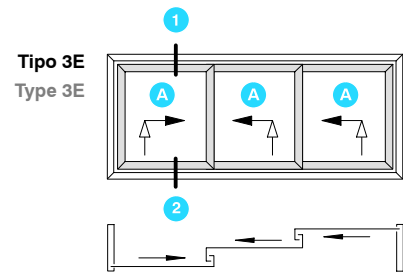

A Hoja corredera / corredera elevable
 S / LS vent

Escala 1:2
 Scale 1:2

Versión con 3 carriles
 Peso máximo de la hoja: 150 kg
 Triple track design
 Max. vent weight: 150 kg

Tipo 3E
 Type 3E

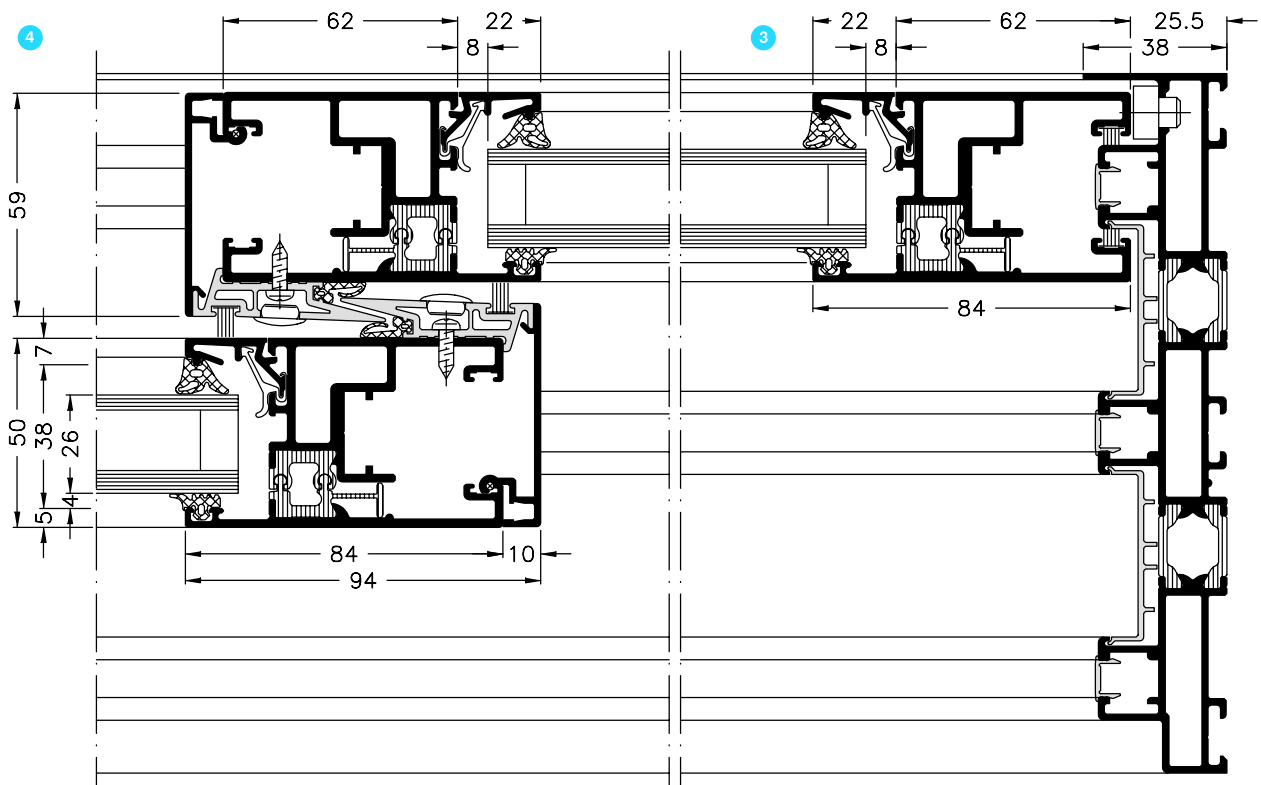
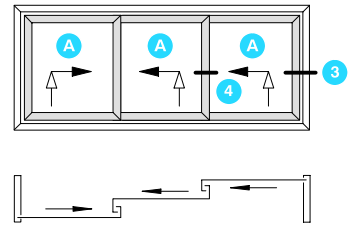

Tipo 3F
 Type 3F

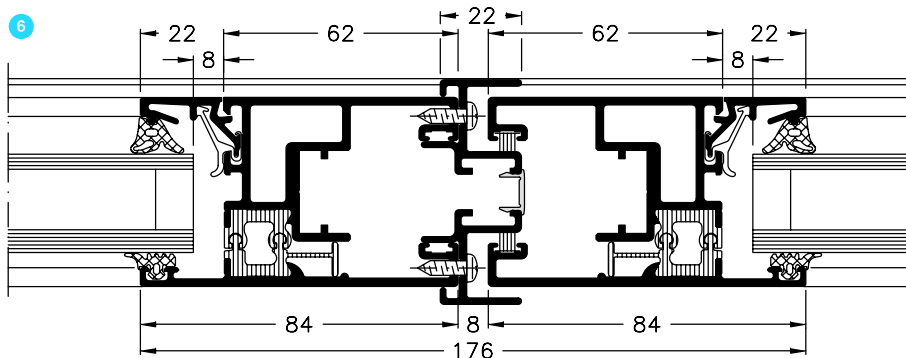
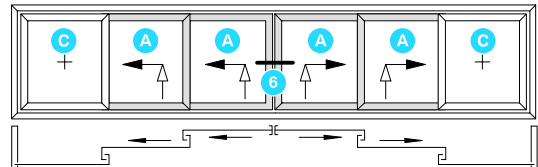

Escala 1:2
 Scale 1:2

Versión con 3 carriles
 Peso máximo de la hoja: 300 kg
 Triple track design
 Max. vent weight: 300 kg

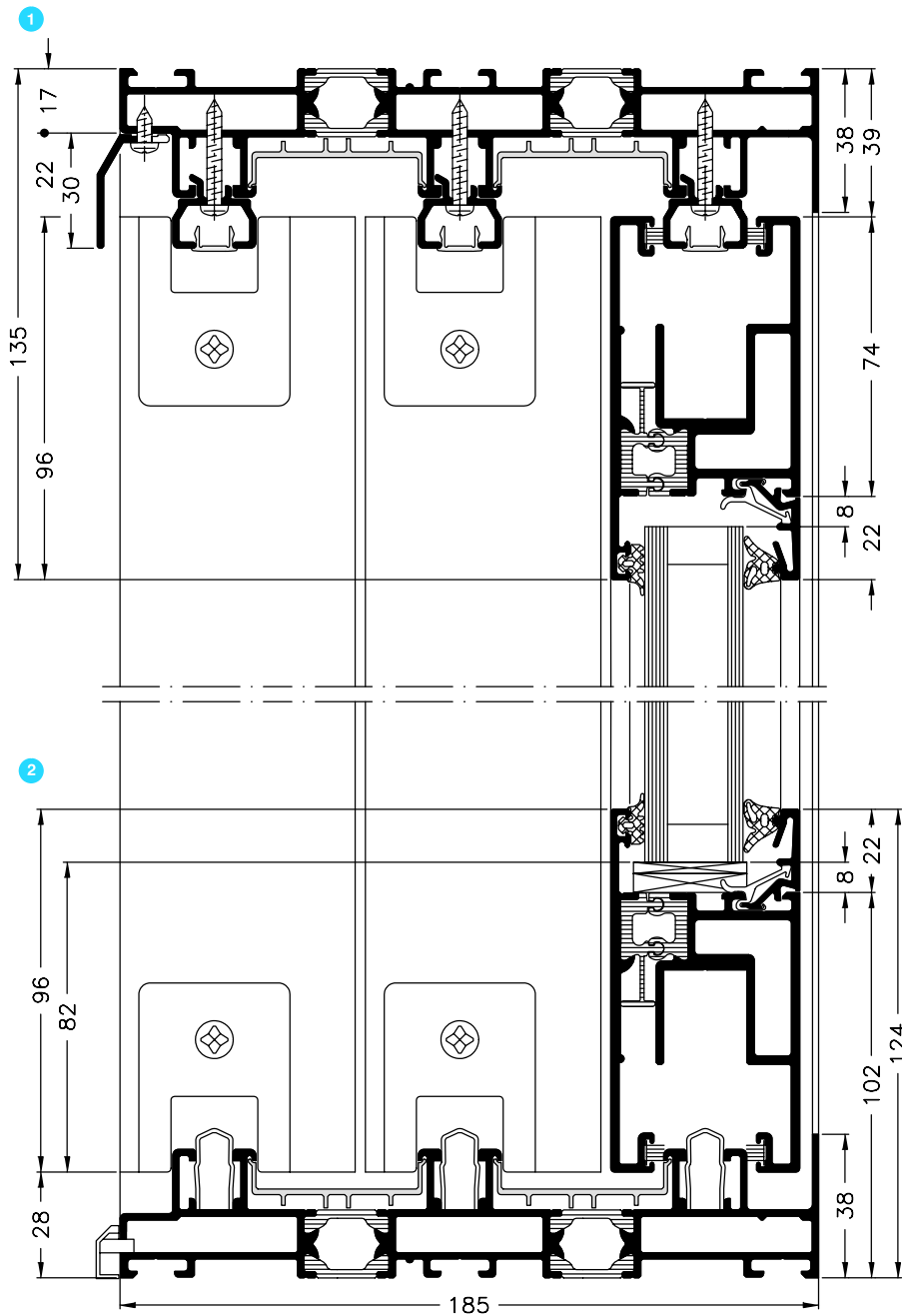
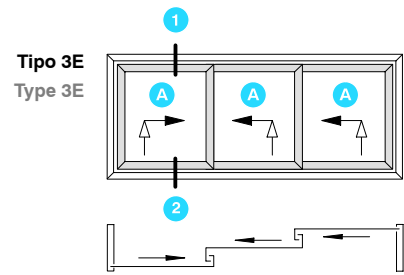

Escala 1:2
 Scale 1:2

- A** Hoja corredera / corredera elevable
S / LS vent
- C** Hoja fija
Fixed vent

Tipo 3E
Type 3E

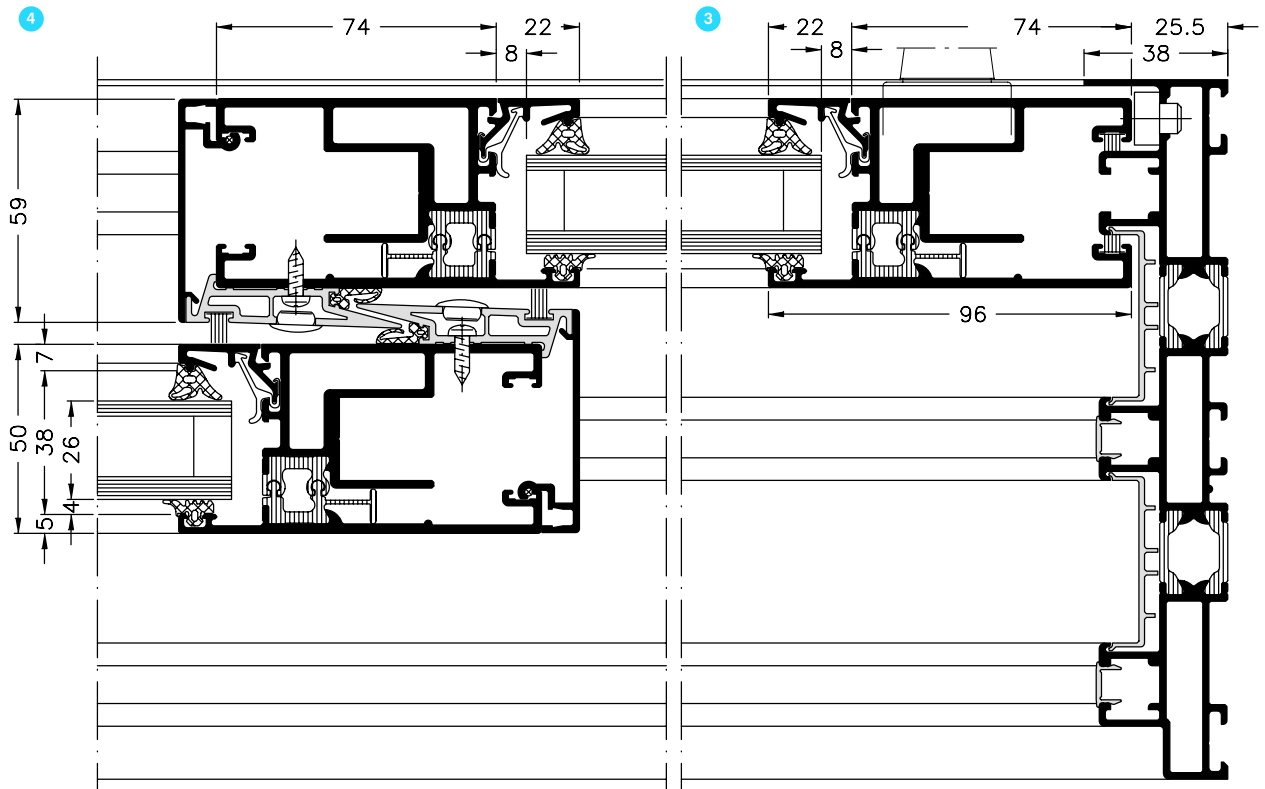
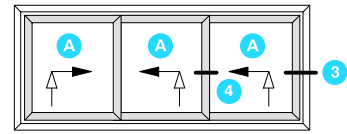

Tipo 3F
Type 3F

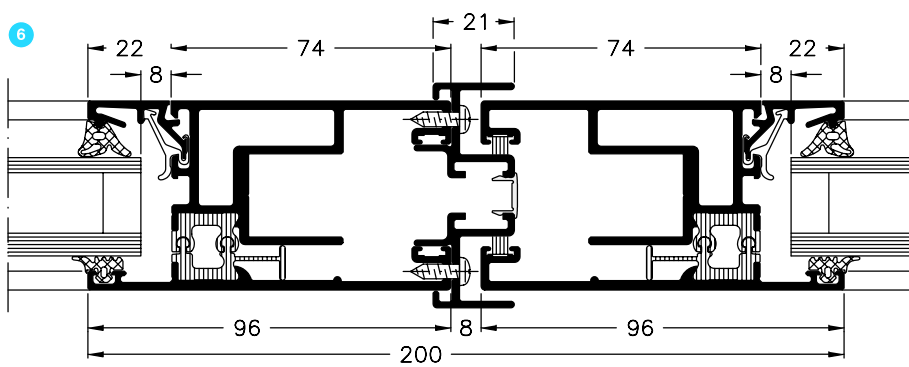
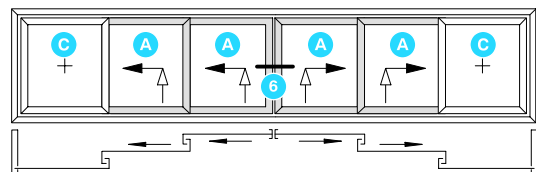

Escala 1:2
Scale 1:2

Montantes Toplights

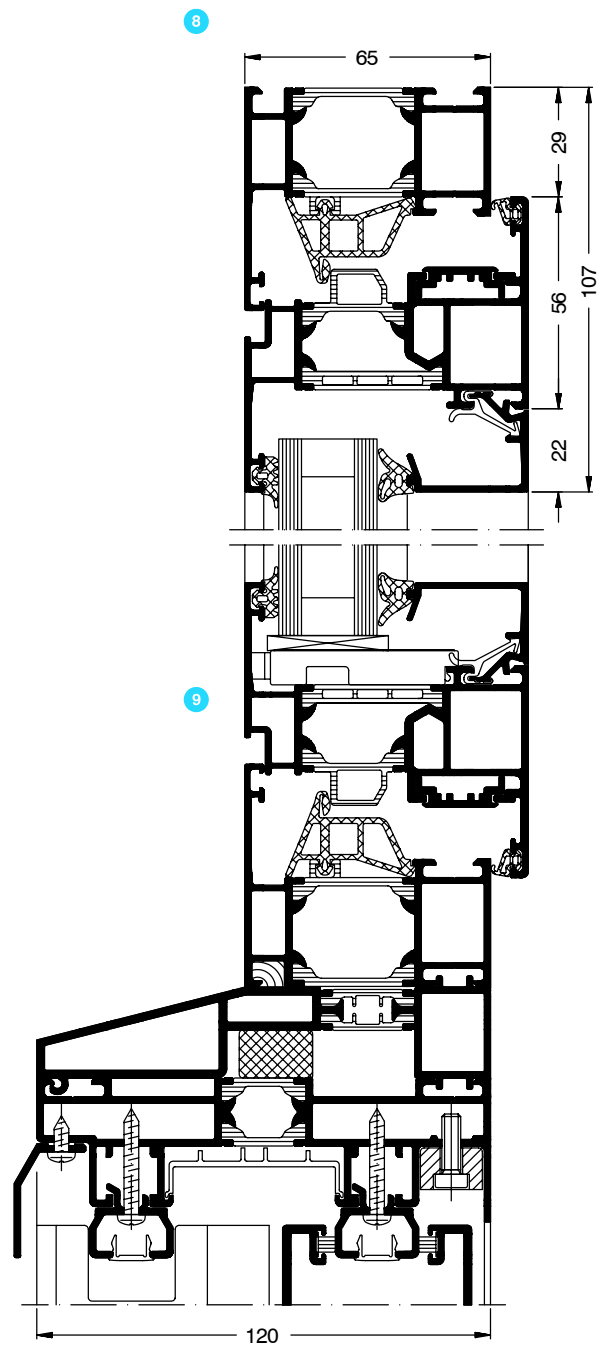
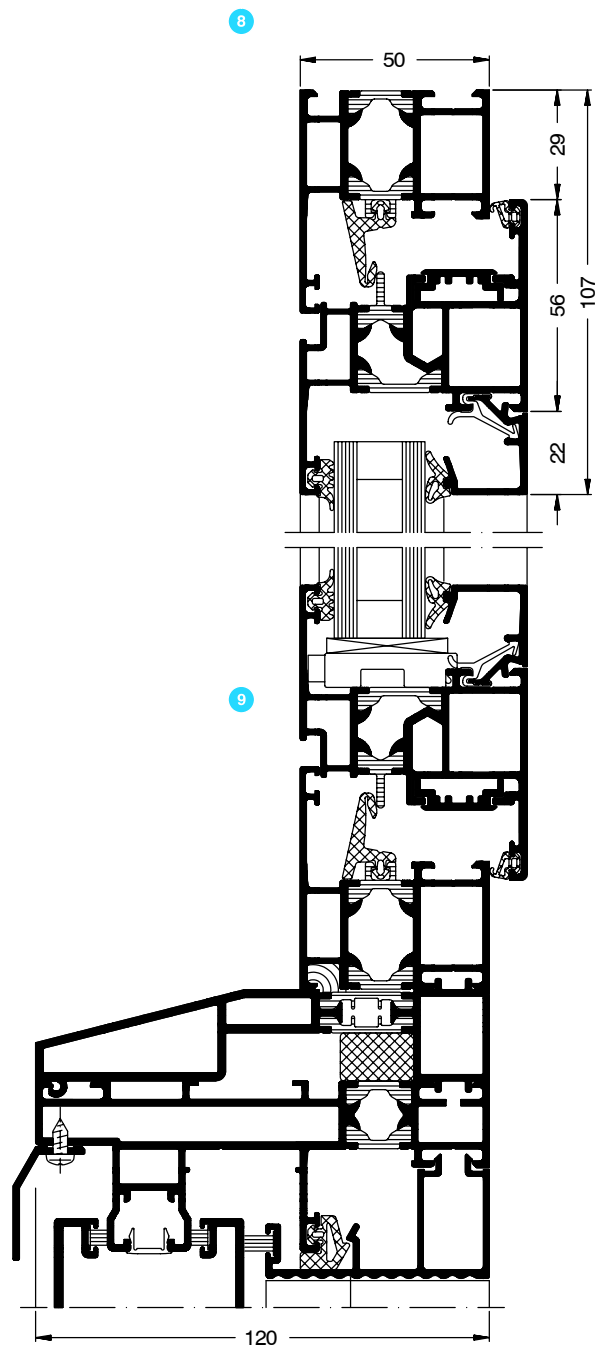
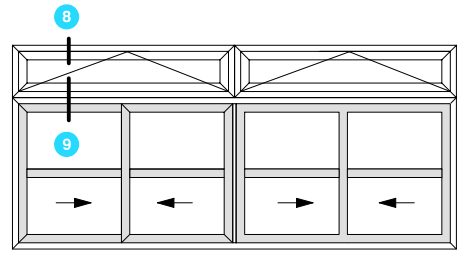
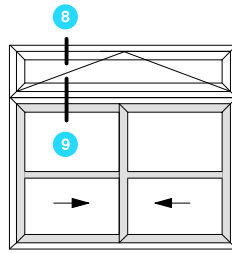

Schüco ASS 70.HI

El sistema Schüco ASS 70.HI proporciona el mejor aislamiento térmico, una estanqueidad perfecta y una protección antirrobo excelente, ofreciendo al mismo tiempo un máximo confort.

The Schüco ASS 70.HI system provides top thermal insulation, perfect weathertightness and excellent burglar resistance with maximum ease of use.



91 Características y ventajas
Features and benefits

94 Posibilidades de aplicación
Possible applications

Schüco ASS 70.HI

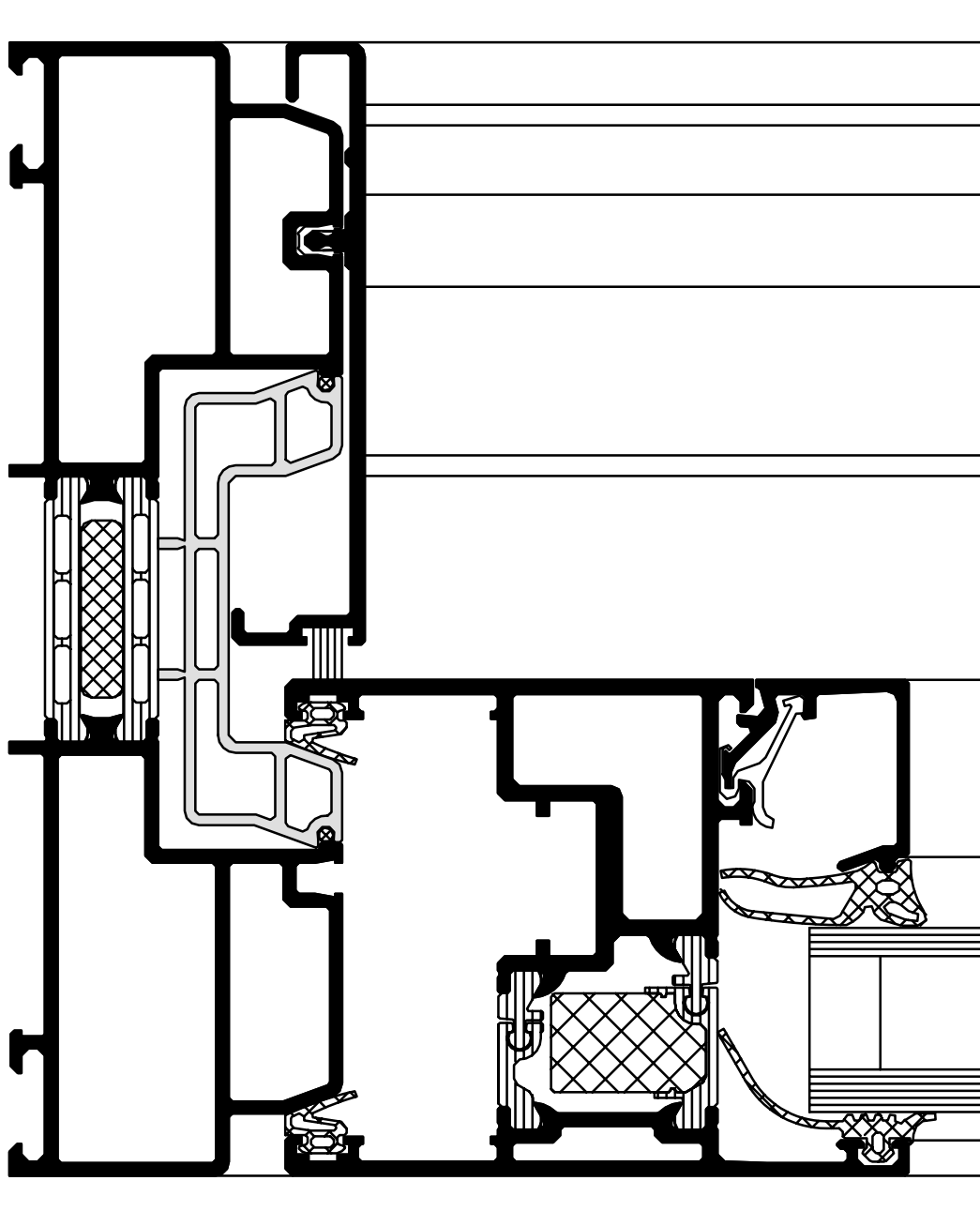

Escala 1:1

Scale 1:1

Características y ventajas

Features and benefits

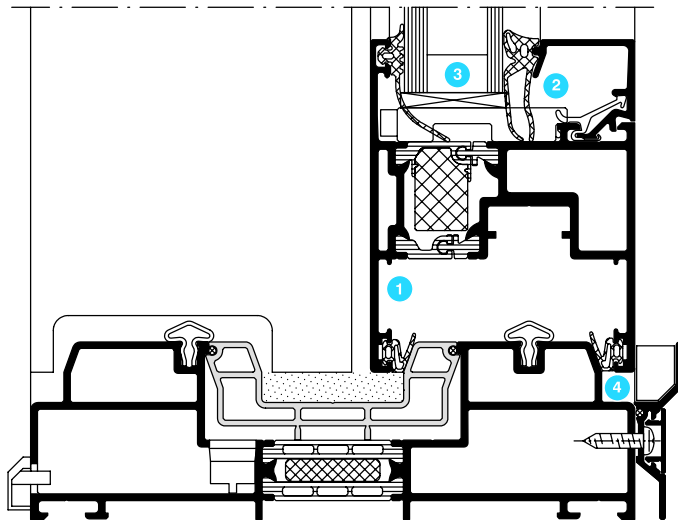

Escala 1:2

Scale 1:2

Estética

- Serie corredera elevable con anchos de vista finos; de marco fino y mayor superficie acristalada
- ① Profundidad de la hoja de 70 mm
Profundidad de marco desde 160 mm
- ② Juntas de acristalamiento de EPDM con labios poco visibles para evitar las típicas "rayas negras"
- Perfiles de hoja y junquillos enrasados también con contornos redondeados de líneas suaves
- Cerco plano y perimetral; umbral bajo para una mejor accesibilidad
- Cerco y hoja están ensamblados a inglete en las cuatro esquinas para ofrecer una apariencia elegante

Funcionalidad

- Gran variedad de colores con posibilidad de elegir diferentes colores para el interior y exterior
- Alto grado de flexibilidad para proyectos a gran escala mediante ensamblaje de los perfiles
- ③ Permite espesores de vidrio hasta 52 mm
- Estanqueidad al agua hasta clase E 750 según DIN EN 12208, en función de la versión
- Se pueden realizar hojas con un peso de hasta 300 kg
- Protección antirrobo WK2 según DIN EN V 1627 en función de la versión
- Gran variedad de modelos, con dos carriles de acero inoxidable
- ④ Deslizamiento suave y silencioso de los elementos corredores
- Aislamiento térmico según DIN EN ISO 10077, parte 1, $U_D < 1,5$ (W/m^2K)

Design

- Lift-and-slide series with narrow profile face widths, proportionally narrow frames to large panes
- ① Basic depth of vent profile 70 mm, basic depth of outer frame profile 160 mm
- ② EPDM glazing gaskets with discreet gasket lips prevent black borders
- Vent profiles and flush-fitted glazing beads also with rounded softline contour
- Flat outer frame profile as continuous frame, low threshold for easy access
- Outer and vent frames are mitred all round, to give an elegant appearance

Functions

- Wide choice of colours, different colours inside and outside
- High degree of flexibility with large-scale projects for customers to roll own profiles together
- ③ Glass thicknesses up to 52 mm possible
- Weathertightness up to class E 750 in accordance with DIN EN 12208, dependent on design
- Vent weights up to 300 kg
- Burglar resistance class WK 2 in accordance with DIN EN V 1627, dependent on design
- A wide range of designs, with stainless steel double tracks
- ④ Units slide smoothly and quietly
- Thermal insulation in accordance with DIN EN ISO 10077, Part 1 $U_D < 1.5$ (W/m^2K)

Posibilidades de aplicación Possible applications

Versión con un peso máximo de la hoja de 150 kg
Max. vent weight: 150 kg

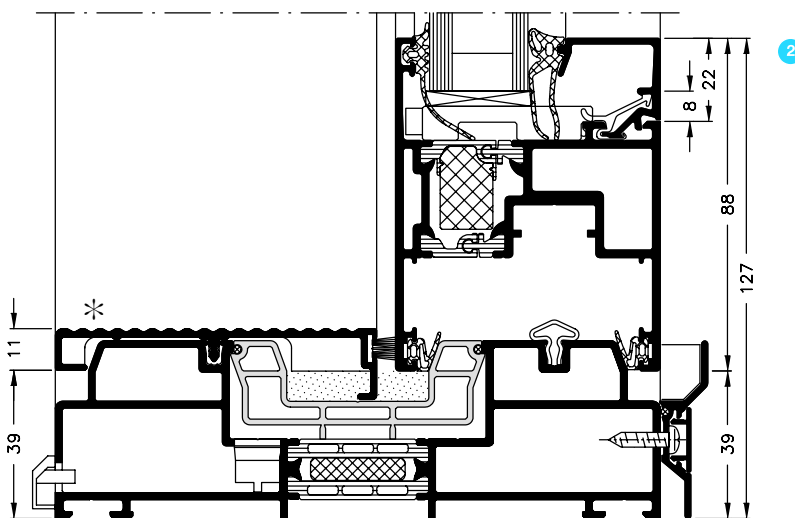
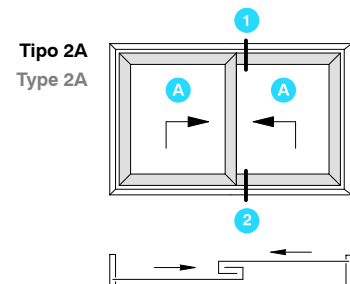
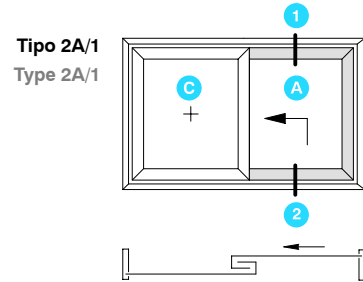
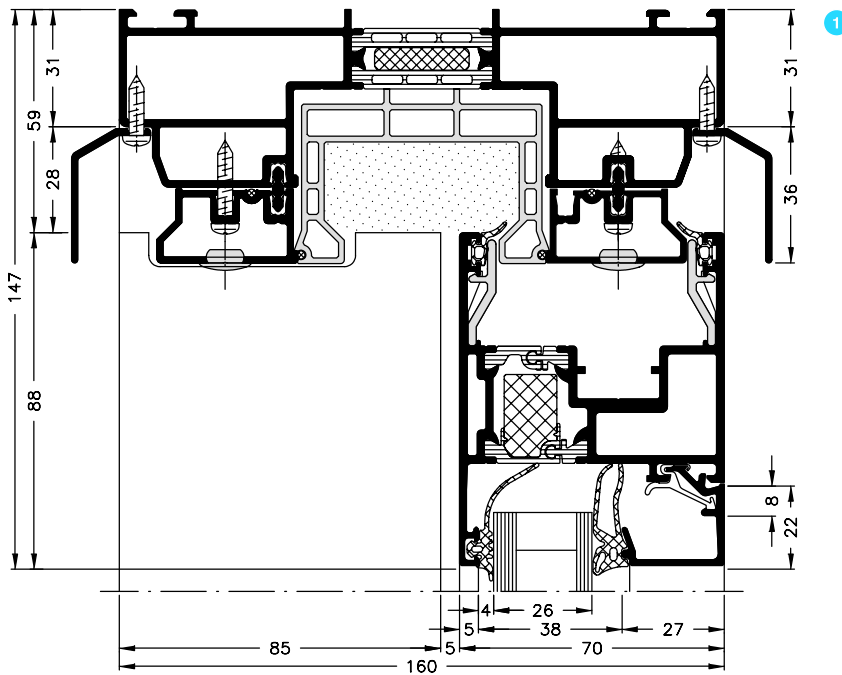

* Perfil antideslizante solamente con 1 hoja corredera tipo 2A/1
Tread plate profile for 1 movable vent only, type 2A/1

Escala 1:2
Scale 1:2

A Hoja corredera elevable
LS vent

C Hoja fija
Fixed vent

Tipo 2A/1
Type 2A/1

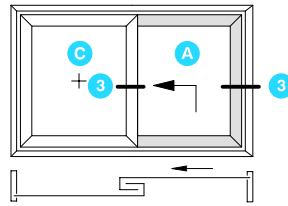

Tipo 2A
Type 2A

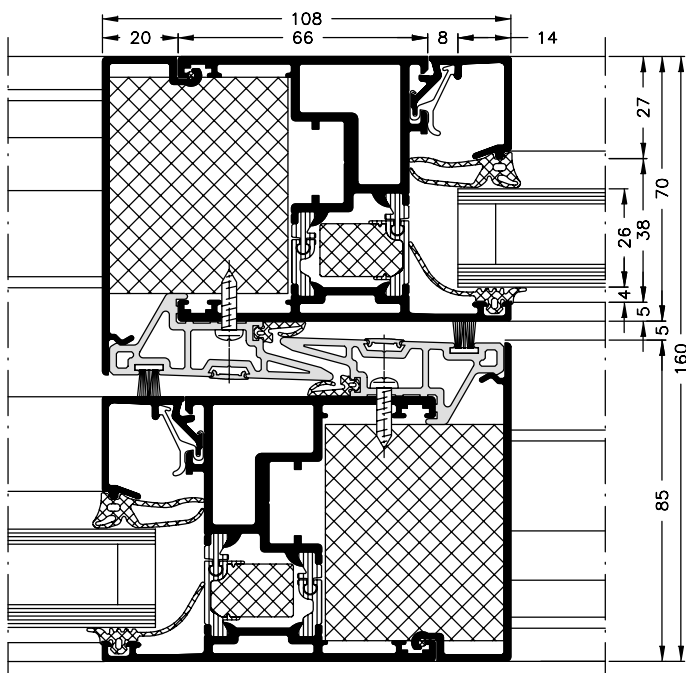
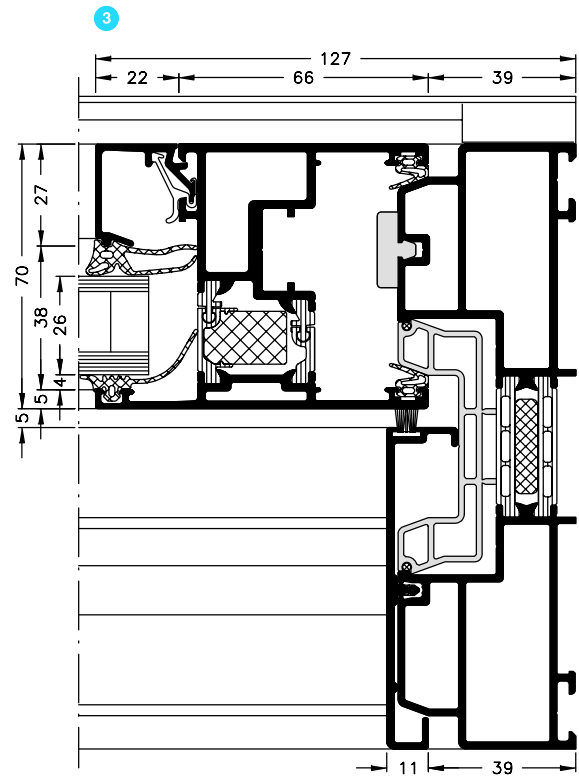
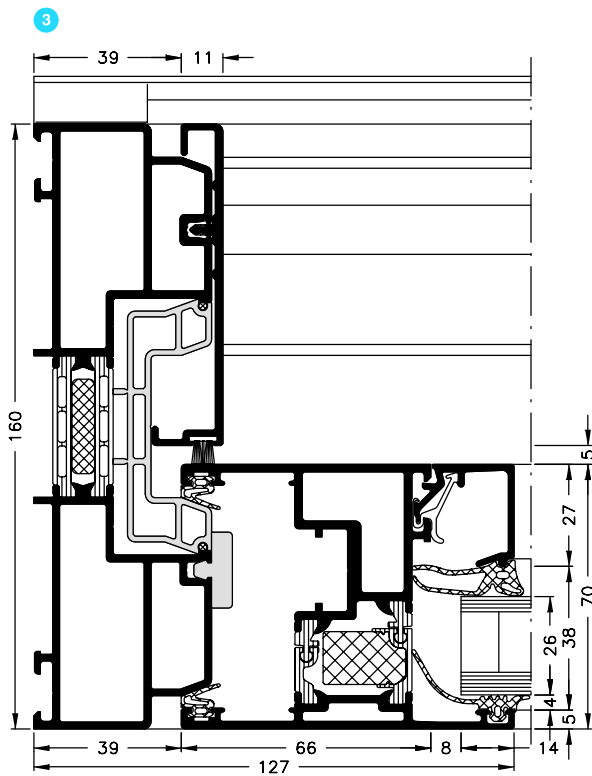
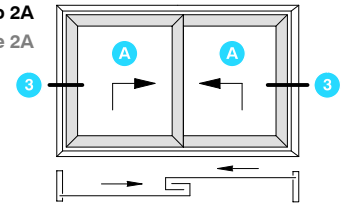

Tipo 2A
Type 2A

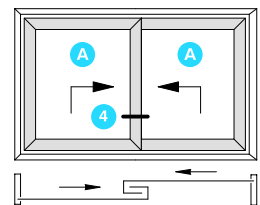

Tipo 2A/1
Type 2A/1

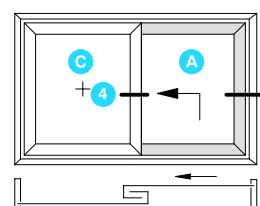

Escala 1:2
Scale 1:2

Versión con un peso máximo de la hoja de 150 kg
 Max. vent weight: 150 kg

Tipo 2A
 Type 2A

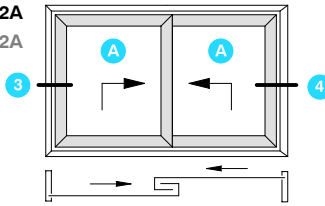

Tipo 2A/1
 Type 2A/1

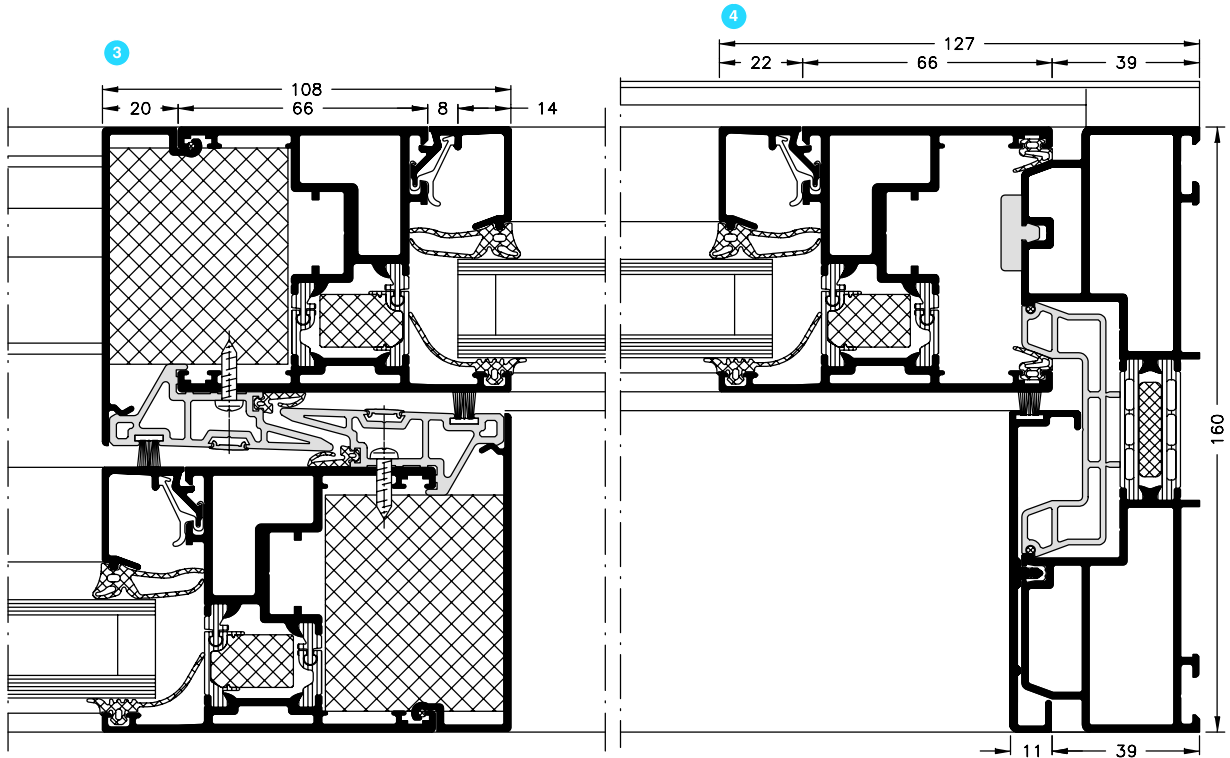
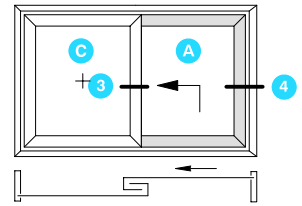

Tipo 2D
 Type 2D

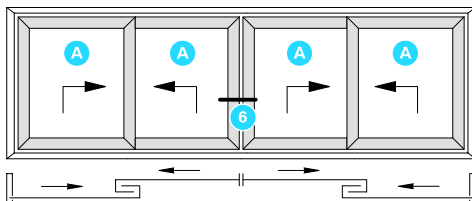

Tipo 2D/1
 Type 2D/1

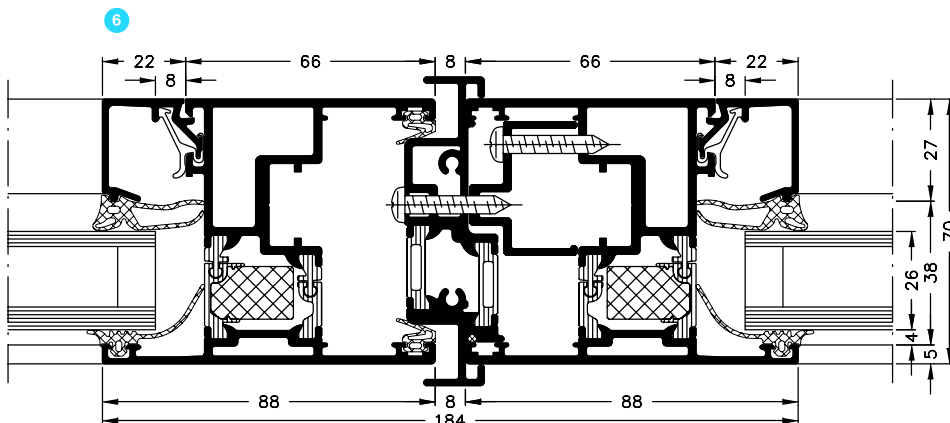
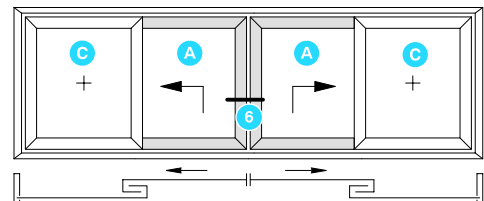

Escala 1:2
 Scale 1:2

Versión con un peso máximo de la hoja de 300 kg
 Max. vent weight: 300 kg

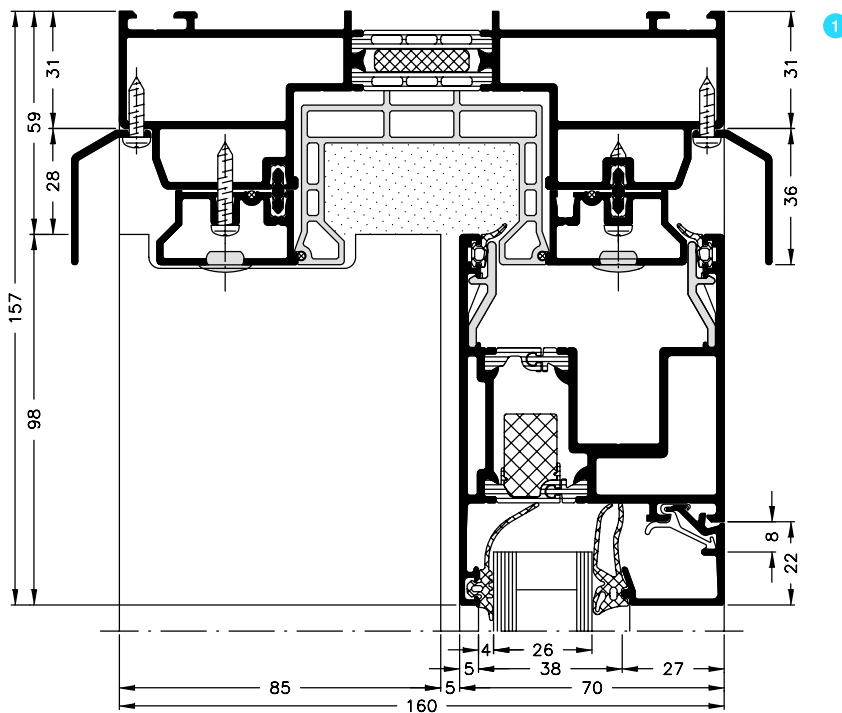

Tipo 2A/1
 Type 2A/1

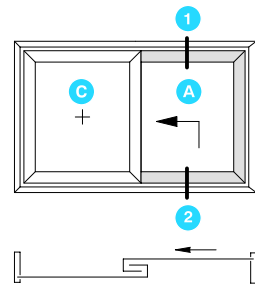

Tipo 2A
 Type 2A

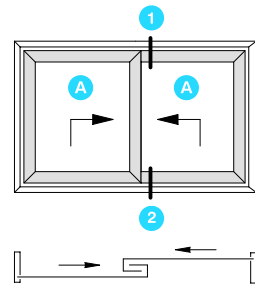

- A Hoja corredera elevable
 LS vent
- C Elemento fijo
 Fixed vent

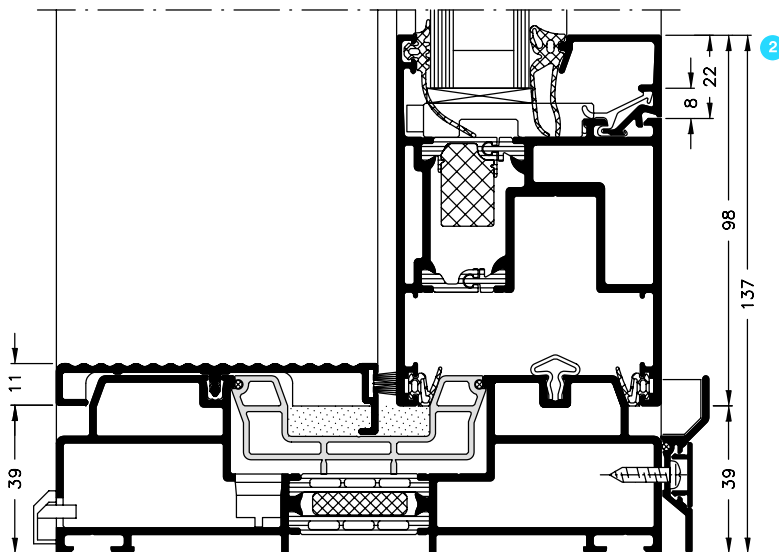

Escala 1:2
 Scale 1:2

Versión con un peso máximo de la hoja de 300 kg
 Max. vent weight: 300 kg

Tipo 2A/1
 Type 2A/1

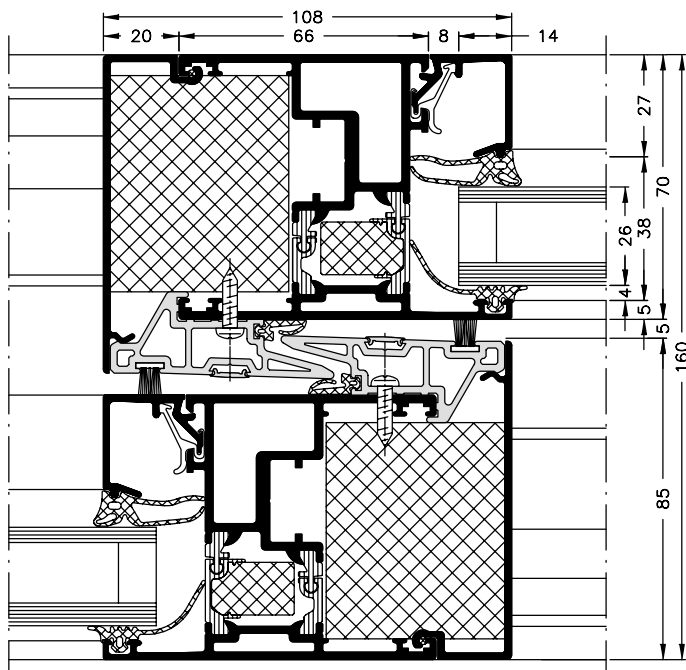
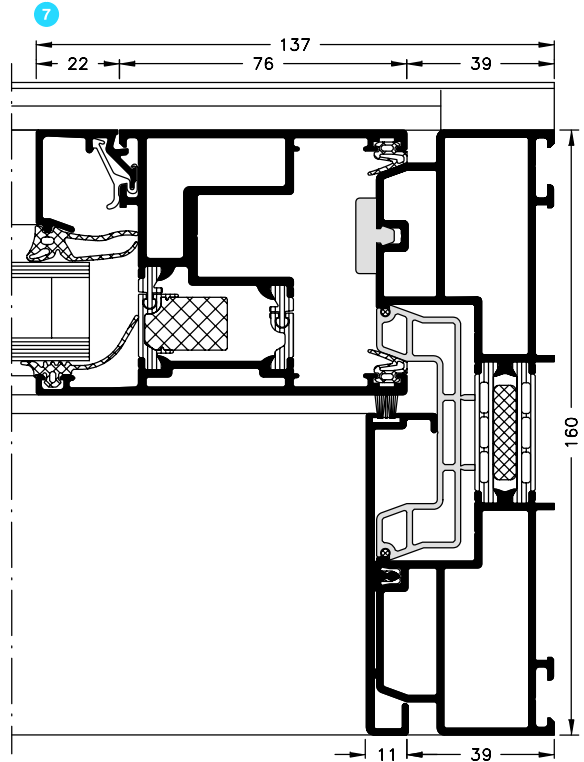
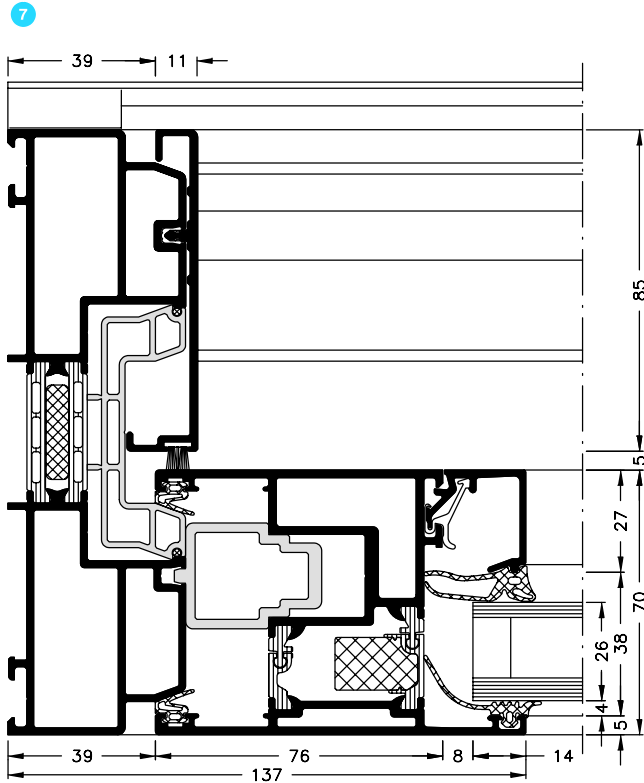
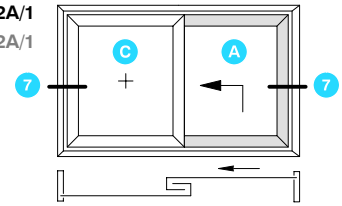

Tipo 2A
 Type 2A

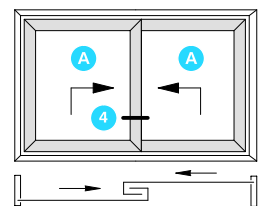

Tipo 2A/1
 Type 2A/1

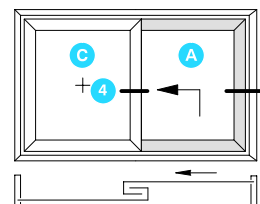

Escala 1:2
 Scale 1:2

- A** Hoja corredera elevable
LS vent
- C** Elemento fijo
Fixed vent

Tipo 2A/1
Type 2A/1

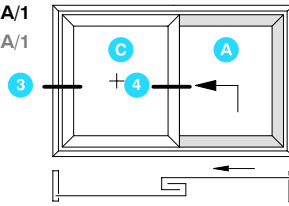

Tipo 2A
Type 2A

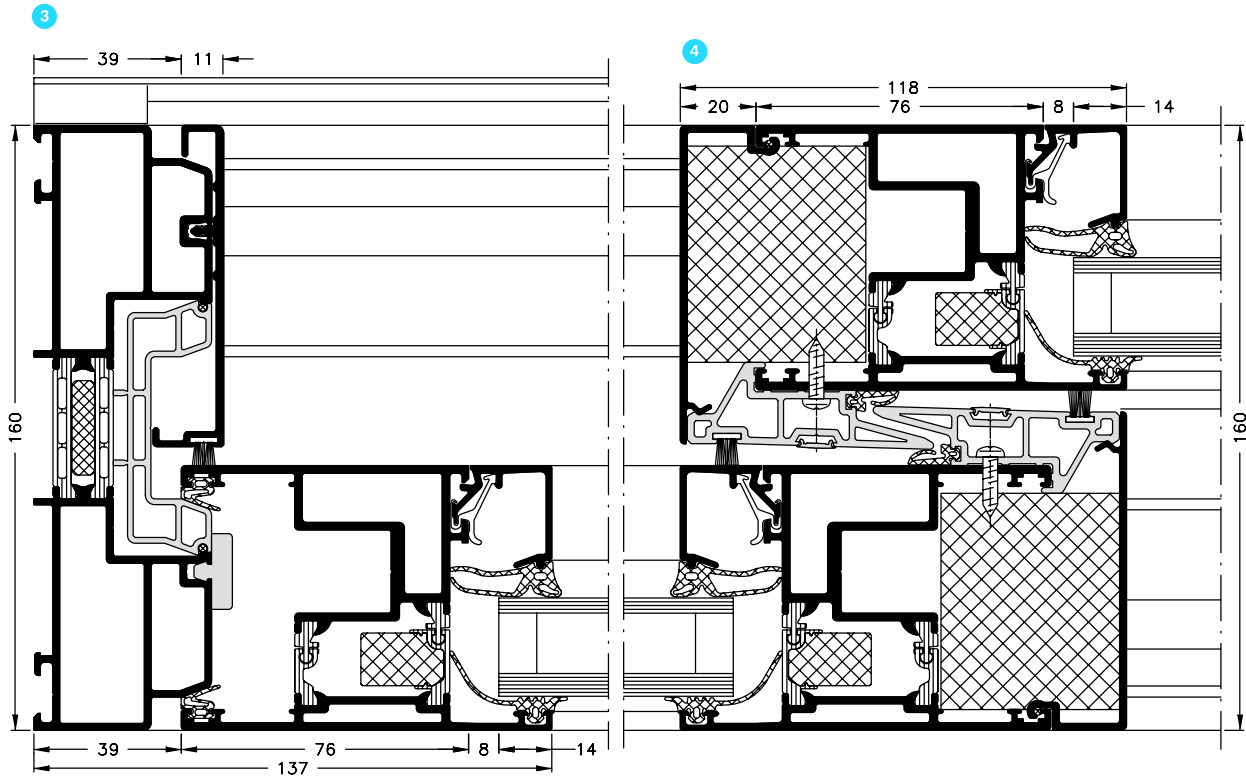
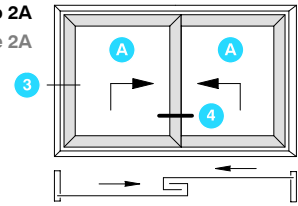

Tipo 2D/1
Type 2D/1

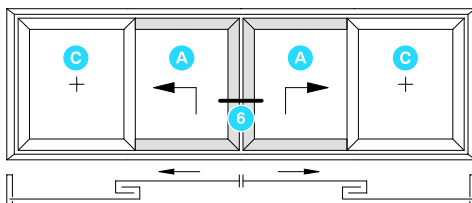

Tipo 2D
Type 2D

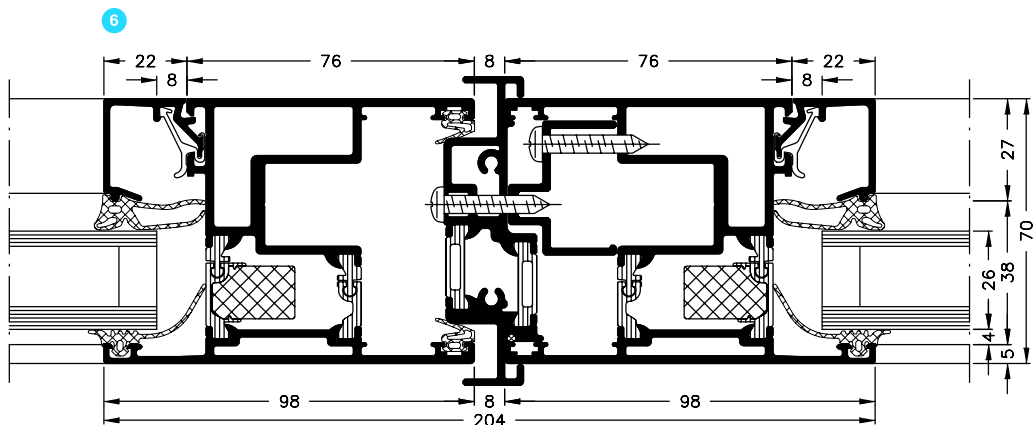
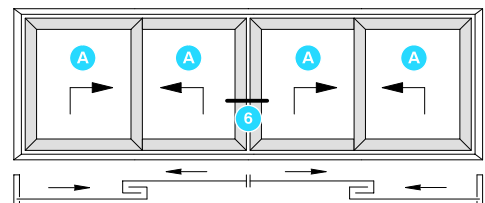

Escala 1:2
Scale 1:2

